

# PVC FITTINGS & VALVES

## Technical Catalogue



## INTRODUCTION

Plasson's innovative products revolutionized the way of connecting polyethylene pipes in the 1960's. We started with fittings for agricultural irrigation and later developed products for urban water distribution.

High pressure PVC Fittings and Valves are part of Plasson's wide range of products. Plasson has achieved superior designs and products and a genuine commitment to quality, delivery and service.

Plasson continues to strive for the future environment. By buying Plasson products you help us invest in our vision of a world where clean, pure water will be everyone's birthright.

### INTRODUCTION

CEMENTED FITTINGS	8-17
ADAPTOR FITTINGS	18-25
THREADED FITTINGS	26-32
FITTINGS ACCESSORIES	33-36
VALVES NORMAL SUPPORT	37-38
VALVES THREADED SUPPORT	39-43
CHECK VALVES	44-45
FOOT VALVES	46
AIR RELEASE VALVES	47
VALVES ACCESSORIES	48-52
TECHNICAL SPECIFICATIONS - FITTINGS	53-54
TECHNICAL SPECIFICATIONS - VALVES	55-56
ASSEMBLY INSTRUCTIONS	57-62

**PRODUCT LIST**

**050100**

**Socket** - Cemented

**page 8**



**054500**

**45° Elbow** - Cemented

**page 14**



**050200**

**Reducing Socket**

Male - Female - Cemented

**page 9**



**055000**

**Flange Adaptor with**

**O-Ring** Cemented

**page 14**



**050400**

**90° Tee** - Cemented

**page 10**



**055100**

**Stub Flat Face to fit**

**055000** Cemented

**page 15**



**050500**

**90° Elbow** - Cemented

**page 10**



**055200**

**Stub Serrated**

Cemented

**page 15**



**050700**

**End Cap** - Cemented

**page 11**



**059000**

**Loose Flange**

**page 16**



**050800**

**Union** - Cemented

**page 11**



**059100**

**Blind Flange**

**page 16**



**050900**

**Short Reducing**

**Bushing** - Cemented

**page 12**

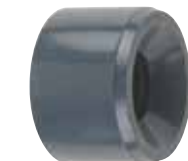

**059200**

**Fixed Flange**

**page 17**



**051400**

**90° Reducing Tee**

Cemented

**page 13**



**050102**

**Socket Adaptor**

Cemented Threaded

**page 18**



**053600**

**House Adaptor**

Cemented

**page 13**



**050202**

**Reducer Adaptor**

M - F - Cemented Threaded

**page 18**



**PRODUCT LIST**

**050302**  
**Adaptor Socket**  
 M - F - Cemented - Threaded  
**page 18**



**051402**  
**90° Reducing Tee**  
 Cemented - Threaded  
**page 21**



**050402**  
**90° Tee**  
 Cemented Threaded  
**page 19**



**057102**  
**Socket Adaptor** Cemented  
 Threaded with Reinforcing Ring  
**page 22**



**050502**  
**90° Elbow**  
 Cemented Threaded  
**page 19**



**057202**  
**Reducer Adaptor with Reinforcing Ring** Male  
 Cemented - Female - Threaded  
**page 22**



**050602**  
**Adaptor**  
 M - F - Cemented - M - Threaded  
**page 19**



**057402**  
**90° Tee with Reinforcing Ring** Cemented Threaded  
**page 23**



**050802**  
**Union Adaptor**  
 F - Cemented - Threaded  
**page 20**



**057502**  
**90° Elbow with Reinforcing Ring** Cemented Threaded  
**page 23**



**052102**  
**Adaptor**  
 M - F - Cemented - M - Threaded  
**page 20**



**058900**  
**Metal Pipe & Tap Connectors**  
**page 24**



**052202**  
**Bushing Adaptor**  
 M - F - Cemented - M - Threaded  
**page 20**



**058100**  
**Metal Pipe & Tap Connectors**  
**page 24**



**053602**  
**House Adaptor With Threaded Nut**  
**page 21**



**058200**  
**Metal Pipe & Tap Connectors**  
**page 25**



**054502**  
**45° Elbow**  
 Cemented - Threaded  
**page 21**



**058901**  
**Metal Pipe & Tap Connectors**  
**page 25**



**PRODUCT LIST**

**050101**  
**Socket - Threaded**  
 page 26



**050804**  
**Union**  
 Male - Female - Threaded  
 page 29



**050103**  
**Socket - Threaded**  
 Female - Female  
 page 26



**051601**  
**Reducing Nipple**  
 Threaded  
 page 30



**050201**  
**Reducer**  
 Male - Female - Threaded  
 page 27



**051701**  
**Plug - Threaded**  
 page 31



**050401**  
**90° Tee - Threaded**  
 page 27



**053601**  
**House Adaptor**  
 Threaded  
 page 31



**050501**  
**90° Elbow - Threaded**  
 page 28



**052201**  
**Nipple Socket**  
 Male - Female - Threaded  
 page 31



**050601**  
**Nipple - Threaded**  
 page 28



**054501**  
**45° Elbow**  
 Threaded  
 page 32



**050701**  
**Cap - Threaded**  
 page 28



**059201**  
**Fixed Flange**  
 Threaded  
 page 32



**050801**  
**Union Female**  
 Threaded  
 page 29



**054800**  
**Nut for Unions:** 050800, 050801  
 050802, 050803, 050804, 053602  
 page 33



**050803**  
**Union Male - Female**  
 Cemented Threaded  
 page 29



**055800**  
**Bushing for Union:**  
 050800  
 page 33



**PRODUCT LIST**

**055801**  
**Bushing for Unions:**  
 050801, 050802  
**page 33**



**113500**  
**One Nut Valve**  
 Cemented  
**page 38**



**055803**  
**Mail Threaded Union**  
**bush** for items 050803, 050804  
**page 34**



**113510**  
**One Nut Valve**  
 Threaded  
**page 38**



**056800**  
**End for Unions:**  
 050800, 050802, 050803  
**page 34**



**113610**  
**One Nut Valve**  
 Male - Female - Threaded  
**page 38**



**056810**  
**End for Unions:**  
 050801, 050804  
**page 34**



**111400**  
**Two Nut Valve**  
 Cemented  
**page 39**



**056090**  
**O-Ring for Item**  
 055000  
**page 35**



**111410**  
**Two Nut Valve**  
 Threaded  
**page 39**



**056290**  
**Seal for:**  
 055200, 053602  
**page 35**



**112400-112700\***  
**Bistop Valve**  
 Cemented  
**page 40**



**056390**  
**O-Ring for Unions** 050800,  
 050801, 050802, 050803 050804  
**page 36**



**112410-112710\***  
**Bistop Valve**  
 Threaded  
**page 40**



**111500**  
**Two Nut Valve**  
 Cemented  
**page 37**



**113400**  
**One Nut Valve**  
 Cemented  
**page 41**



**111510**  
**Two Nut Valve**  
 Threaded  
**page 37**



**113410**  
**One Nut Valve**  
 Threaded  
**page 41**



**PRODUCT LIST**

**113710**  
**One Nut Valve**

Threaded  
**page 42**



**116300-116900**  
**Air Release Valve**

Cemented  
**page 47**



**113790**  
**One Nut Valve**

Female - Threaded - Compression  
**page 42**



**116310-116910**  
**Air Release Valve**

Threaded  
**page 47**



**111480**  
**Two Nut Valve**

PE End Connector  
**page 43**



**111100**  
**Valve Collar**

Cemented  
**page 48**



**113780**  
**One Nut Valve**  
**Compressor PE End**  
**Connector**

**page 43**



**111110**  
**Valve Collar**

Threaded  
**page 48**



**110800-110600**  
**110900-110000**

Check Valve Cemented  
**page 44**



**11112**  
**Blue Handles**  
**page 49**



**110810-110610**  
**110910-110010**

Check Valve Threaded  
**page 44**



**11113**  
**Red Handles**  
**page 49**



**050408**  
**Knocker Tee**

Cemented  
**page 45**



**111140**  
**Valve Nut**  
**page 50**



**116400-116000**  
**Foot Valve**

Cemented  
**page 46**



**1115.207**  
**PE End Connector**  
**page 50**



**116410-116010**  
**Foot Valve**

Threaded  
**page 46**



**PVC CEMENTED FITTINGS**

**050100**  
**Socket - Cemented**

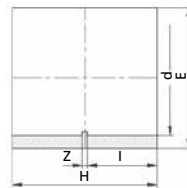

Quality	Cod	d	E	H	I	Z	Weight	PN	Pack
U C K	050100016	16	21	30	14	2	7	16	2500
U C K	050100020	20	25	35	16	3	8	16	1500
U C K	050100025	25	30	42	19	4	11	16	1000
U C K	050100032	32	38	48	22	4	20	16	600
U C K	050100040	40	48	56	26	4	42	16	300
U C K	050100050	50	58	66	31	4	64	16	180
U C K	050100063	63	73	80	38	4	119	16	100
U C K	050100075	75	88	93	44	5	234	16	100
U C K	050100090	90	104	108	51	6	325	16	60
U C	050100110	110	126	128	61	6	525	16	28
U	050100125	125	143	145	69	7	803	16	24
U	050100140	140	161	160	76	8	1074	16	18
U	050100160	160	181	181	86	9	1339	16	9
U	050100200	200	228	224	106	12	2778	10	4
	050100225	225	250	257	119	19	3670	10	3
	*050100250	250	287	275	133	10	5800	10	2
	*050100280	280	320	304	147	10	7750	10	1
	*050100315	315	355	342	165	12	9820	10	1

Quality certifications : U= UNI-IIP, C= NF-CSTB, K = Kiwa

\* DELIVERY PROGRAM



## PVC CEMENTED FITTINGS

### 050200 Reducing Socket Male - Female - Cemented

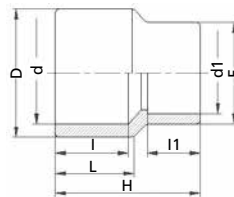

Cod	Dxdxd1	L	I	l1	E	H	Weight	PN	Pack
050200020016	20 x 16 x 16	16	14	14	20	36	6	16	3000
050200025016	25 x 20 x 16	19	16	14	22	39	10	16	1500
050200025020	25 x 20 x 20	19	16	16	25	42	10	16	1500
050200032016	32 x 25 x 16	22	19	14	22	41	15	16	1000
050200032020	32 x 25 x 20	22	19	19	25	45	16	16	1000
050200032025	32 x 25 x 25	22	19	19	31	50	20	16	800
050200040016	40 x 32 x 16	26	22	14	22	50	23	16	800
050200040020	40 x 32 x 20	26	22	16	26	52	26	16	700
050200040025	40 x 32 x 25	26	24	19	32	49	27	16	500
050200040032	40 x 32 x 32	26	22	29	39	57	35	16	500
050200050020	50 x 40 x 20	31	26	16	27	61	50	16	400
050200050025	50 x 40 x 25	31	26	19	33	62	50	16	300
050200050032	50 x 40 x 32	33	26	22	40	65	55	16	300
050200050040	50 x 40 x 40	31	26	26	49	69	65	16	300
050200063025	63 x 50 x 25	38	31	19	32	72	88	16	170
050200063032	63 x 50 x 32	38	31	22	40	76	93	16	170
050200063040	63 x 50 x 40	38	33	26	49	79	100	16	150
050200063050	63 x 50 x 50	34	31	47	61	85	123	16	150
050200075032	75 x 63 x 32	44	38	22	40	86	120	16	190
050200075040	75 x 63 x 40	44	38	26	49	87	130	16	170
050200075050	75 x 63 x 50	44	41	42	61	92	150	16	150
050200075063	75 x 63 x 63	44	38	38	73	100	163	16	110
050200090040	90 x 75 x 40	51	44	26	49	99	225	16	110
050200090050	90 x 75 x 50	51	44	31	62	103	232	16	100
050200090063	90 x 75 x 63	51	44	38	74	111	259	16	100
050200090075	90 x 75 x 75	51	44	44	89	117	290	16	80
050200110050	110 x 90 x 50	61	51	31	61	117	410	16	80
050200110063	110 x 90 x 63	61	51	38	76	125	441	16	65
050200110075	110 x 90 x 75	61	51	44	90	133	490	16	35
050200110090	110 x 90 x 90	61	51	51	106	138	545	16	45
050200125063	125 x 110 x 63	69	61	38	78	121	460	16	44
050200125075	125 x 110 x 75	69	61	44	90	125	460	16	44
050200125090	125 x 110 x 90	69	61	51	104	126	460	16	44
050200125110	125 x 110 x 110	69	61	61	123	127	440	16	32
050200140110	140 x 125 x 110	76	69	61	130	149	645	16	24
050200160110	160 x 140 x 110	86	76	61	130	157	825	16	25
050200160125	160 x 140 x 125	86	76	69	145	160	890	16	18
050200225160	225 x 200 x 160	119	106	86	185	230	2100	10	6

**PVC CEMENTED FITTINGS**

**050400**  
**90° Tee - Cemented**

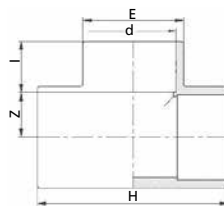

Quality	Cod	d	E	H	l	Z	Weight	PN	Pack
U C K	050400016	16	23	46	14	9	18	16	1500
U C K	050400020	20	27	55	16	12	22	16	700
U C K	050400025	25	30	65	19	14	44	16	500
U C K	050400032	32	40	78	22	17	54	16	250
U C K	050400040	40	48	99	26	23	97	16	130
U C K	050400050	50	62	118	31	28	212	16	80
U C K	050400063	63	73	145	38	35	372	16	56
U C K	050400075	75	90	169	44	41	540	16	35
U C K	050400090	90	108	199	51	49	970	16	24
U C	050400110	110	129	239	61	59	1510	16	14
U	050400125	125	148	270	69	66	2234	16	9
U	050400140	140	162	298	76	73	2650	16	6
U	050400160	160	184	339	86	84	3793	10	3
	*050400200	200	232	420	106	102	7200	10	2
	*050400225	225	258	465	119	114	9700	10	1
	*050400250	250	286	519	132.5	127	12070	10	1
	*050400280	280	319	579	147.5	142	17480	10	1
	*050400315	315	360	648	165	159	24350	10	1

Quality certifications : U= UNI-IIP, C= NF-CSTB, K = Kiwa

\* DELIVERY PROGRAM

**050500**  
**90° Elbow - Cemented**

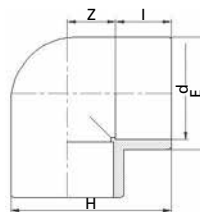

Quality	Cod	d	E	H	l	Z	Weight	PN	Pack
U C K	050500016	16	23	35	14	9	13	16	1800
U C K	050500020	20	25	41	16	12	21	16	1000
U C K	050500025	25	31	48	19	14	32	16	600
U C K	050500032	32	39	58	22	17	40	16	350
U C K	050500040	40	47	73	26	23	69	16	200
U C K	050500050	50	59	88	32	27	125	16	130
U C K	050500063	63	73	110	38	35	300	16	60
U C K	050500075	75	90	130	44	41	450	16	50
U C K	050500090	90	108	154	51	49	730	16	30
U C	050500110	110	132	186	61	59	1232	16	17
U	050500125	125	148	211	69	66	1668	16	12
U	050500140	140	162	230	76	73	1970	16	9
U	050500160	160	184	262	86	84	2850	16	5
	*050500200	200	232	324	106	102	5850	10	3
	*050500225	225	258	362	119	114	7500	10	2
	*050500250	250	286	445	132	188	12150	10	1
	*050500280	280	316	496	146	210	15620	10	1
	*050500315	315	358	559	162	239	23500	10	1

Quality certifications : U= UNI-IIP, C= NF-CSTB, K = Kiwa

\* DELIVERY PROGRAM

## PVC CEMENTED FITTINGS

### 050700

#### End Cap - Cemented



Quality	Cod	d	E	H	l	Weight	PN	Pack
U C K	050700016	16	21	20	14	5	16	3000
U C K	050700020	20	25	24	16	10	16	2500
U C K	050700025	25	30	28	19	16	16	1400
U C K	050700032	32	38	32	22	28	16	1000
U C K	050700040	40	48	42	26	51	16	500
U C K	050700050	50	58	47	31	60	16	320
U C K	050700063	63	73	57	38	106	16	150
U C K	050700075	75	88	63	44	179	16	75
U C K	050700090	90	104	73	51	270	16	45
U C	050700110	110	126	85	61	416	16	25
U	050700125	125	143	98	69	640	16	40
U	050700140	140	161	108	76	905	16	30
U	050700160	160	181	123	86	1160	16	20

Quality certifications : U= UNI-IIP, C= NF-CSTB, K = Kiwa

### 050800

#### Union - Cemented

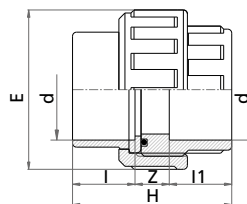

Cod	d	E	H	l	L1	Z	Weight	PN	Pack
050800016	16	34	39	14	14	11	9	16	1200
050800020	20	42	45	16	16	13	15	16	580
050800025	25	52	51	19	19	13	24	16	400
050800032	32	59	58	22	22	13	91	16	250
050800040	40	66	67	26	26	15	140	16	150
050800050	50	79	79	31	31	17	177	16	100
050800063	63	96	95	38	38	19	305	16	60
050800075	75	118	110	44	44	22	210	10	45
050800090	90	132	125	51	51	23	345	10	30
050800110	110	151	145	61	61	23	525	10	18

**PVC CEMENTED FITTINGS**

**050900  
Short Reducing  
Bushing - Cemented**

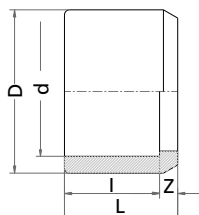

Quality	Cod	Dxd	L	l	z	Weight	PN	Pack
U C	050900020016	20 x 16	16	14	2	3	16	4500
U	050900025016	25 x 16	19	14	5	8	16	3000
U C	050900025020	25 x 20	19	16	3	5	16	3000
U	050900032016	32 x 16	22	14	8	15	16	1800
U	050900032020	32 x 20	22	16	6	15	16	1800
U C	050900032025	32 x 25	22	19	3	10	16	1800
U	050900040020	40 x 20	26	16	10	25	16	1100
U	050900040025	40 x 25	26	23	6	27	16	1000
U C	050900040032	40 x 32	26	22	4	17	16	1000
U	050900050025	50 x 25	31	19	12	43	16	550
U	050900050032	50 x 32	31	22	9	50	16	550
U C	050900050040	50 x 40	31	26	5	32	16	600
U	050900063032	63 x 32	38	22	16	76	16	360
U	050900063040	63 x 40	38	26	12	83	16	300
U C	050900063050	63 x 50	38	34	6	60	16	300
U	050900075040	75 x 40	44	26	18	121	16	126
U	050900075050	75 x 50	44	31	13	95	16	126
U C	050900075063	75 x 63	44	38	6	80	16	126
U	050900090050	90 x 50	51	31	20	195	16	80
U	050900090063	90 x 63	51	38	13	183	16	80
U C	050900090075	90 x 75	51	44	7	141	16	80
U	050900110063	110 x 63	61	38	23	344	16	40
U	050900110075	110 x 75	61	44	17	315	16	40
U C	050900110090	110 x 90	61	51	10	265	16	40
U	050900125075	125 x 75	69	44	25	450	16	60
U	050900125090	125 x 90	69	51	18	430	16	60
U	050900125110	125 x 110	69	61	8	265	16	60
	050900140090	140 x 90	76	51	25	590	16	48
	050900140110	140 x 110	76	61	15	447	16	48
	050900140125	140 x 125	76	69	7	326	16	48
	050900160110	160 x 110	86	61	25	775	16	30
	050900160125	160 x 125	86	69	17	725	16	30
	050900160140	160 x 140	86	76	10	560	16	36
	050900200160	200 x 160	106	86	20	1400	10	15
	050900225160	225 x 160	119	86	33	2450	10	10
	050900225200	225 x 200	119	106	13	1406	10	10
	*050900250160	250 x 160	134	87	47	2184	10	8
	*050900250200	250 x 200	134	107	27	2700	10	8
	*050900250225	250 x 225	132	120	12	2100	10	6
	*050900280225	280 x 225	147	120	27	3090	10	6
	*050900280250	280 x 250	147	132	15	2520	10	6
	*050900315200	315 x 200	165	107	58	8550	10	4
	*050900315225	315 x 225	165	132	33	8085	10	4
	*050900315250	315 x 250	165	132	33	4100	10	4
	*050900315280	315 x 280	165	149	16	4630	10	4

Quality certifications : U = UNI-IIP, C = NF-CSTB

\* DELIVERY PROGRAM

**PVC CEMENTED FITTINGS**

**051400**  
**90° Reducing Tee**  
Cemented

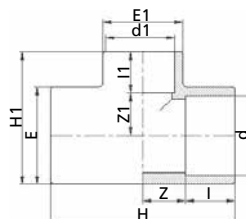

Cod	dxd1xd	E	E1	I	I1	Z	Z1	H	H1	Weight	PN	Pack
051400025020	25 x 20 x 25	33	27	19	16	14	12.5	66	45	36	16	500
051400032020	32 x 20 x 32	42	33	22	16	17	27.5	78	54	69	16	300
051400032025	32 x 25 x 32	41	33	22	19	17	17.5	78	57	63	16	300
051400040020	40 x 20 x 40	50	30	26	16	23.5	22	99	63	104	16	180
051400040025	40 x 25 x 40	50	37	26	24	23.5	22	99	66	110	16	160
051400040032	40 x 32 x 40	50	44	26	22	23.5	22	99	72	120	16	150
051400050025	50 x 25 x 50	62	37	31	24	28	27.5	118	77	188	16	80
051400050032	50 x 32 x 50	61	41	31	22	28	27.5	118	80	190	16	80
051400050040	50 x 40 x 50	61	50	31	26	28	27.5	118	84	180	16	80
051400063032	63 x 32 x 63	77	41	38	22	34	34.5	144	95	335	16	56
051400063040	63 x 40 x 63	77	50	38	26	34	34.5	144	99	340	16	56
051400063050	63 x 50 x 63	77	61	38	31	34	34.5	144	104	350	16	56

**053600**  
**House Adaptor**  
Cemented

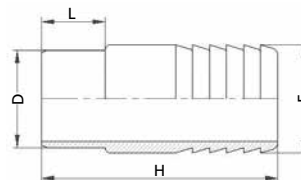

Cod	d	E	H	L	Weight	PN	Pack
053600012	12	12	48	10	4	16	7200
053600016	16	16	58	14	8	16	3600
053600020	20	20	64	16	14	16	2000
053600025	25	25	75	19	26	16	1200
053600032	32	30	88	22	33	16	600
053600040	40	40	95	26	60	16	320
053600050	50	50	102	31	120	16	200
053600063	63	60	118	38	163	16	120

**PVC CEMENTED FITTINGS**

**054500**  
**45° Elbow - Cemented**

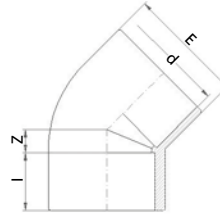

Quality	Cod	d	E	Z	l	Weight	PN	Pack
U C K	054500016	16	23	5	14	11	16	1800
U C K	054500020	20	26	5	16	12	16	1400
U C K	054500025	25	31	6	19	20	16	850
U C K	054500032	32	39	8	22	32	16	450
U C K	054500040	40	48	10	26	63	16	250
U C K	054500050	50	59	12	31	98	16	120
U C K	054500063	63	74	15	38	210	16	80
U C K	054500075	75	91	17	44	366	16	65
U C K	054500090	90	109	21	51	567	16	35
U C	054500110	110	129	25	61	850	16	21
U	054500125	125	148	28	69	1320	16	14
U	054500140	140	163	31	76	1620	16	12
U	054500160	160	184	35	86	2180	16	6
	*054500200	200	232	45	106	5000	10	3
	*054500225	225	258	50	119	6200	10	2
	*054500250	250	287	58	131.5	7680	10	2
	*054500280	280	320	62	147	10350	10	1
	*054500315	315	360	66	165	14480	10	1

Quality certifications : U= UNI-IIP, C= NF-CSTB, K = Kiwa

\* DELIVERY PROGRAM

**055000**  
**Flange Adaptor with O-Ring**  
**Cemented**

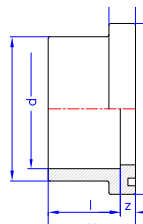

Quality	Cod	d	E	E1	l	Z	B	H	Weight	PN	Pack
U	055000020	20	27	34	16	6	10	22	12	16	2000
U	055000025	25	33	41	19	6	10	25	18	16	1200
U	055000032	32	41	50	22	6	10	28	27	16	850
U	055000040	40	50	61	26	8	13	34	55	16	400
U	055000050	50	61	73	31	8	13	39	70	16	270
U	055000063	63	76	90	38	8	14	46	120	16	160
U	055000075	75	88	106	44	8	15	53	175	16	135
U	055000090	90	105	125	51	10	16	61	270	16	75
U	055000110	110	126	150	61	11	18	72	420	16	48
U	055000125	125	146	169	69	11	17	80	670	16	40
U	055000140	140	163	188	76	12	18	88	860	16	21
U	055000160	160	185	213	86	12	19	98	1140	16	16
	055000200	200	228	254	106	13	23	119	1300	10	8
	055000225	225	249	272	119	14	25	133	1500	10	6

Quality certifications : U = UNI-IIP

## PVC CEMENTED FITTINGS

### 055100 Stub Flat Face to fit 055000 Cemented

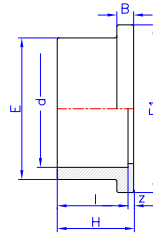

Quality	Cod	d	E	E1	I	Z	B	H	Weight	PN	Pack
U	055100020	20	27	34	16	3	7	19	10	16	2000
U	055100025	25	33	41	19	3	7	22	16	16	1200
U	055100032	32	41	50	22	3	7	25	25	16	850
U	055100040	40	50	61	26	3	8	29	40	16	400
U	055100050	50	61	73	31	3	8	34	60	16	270
U	055100063	63	76	90	38	3	9	41	100	16	160
U	055100075	75	88	106	44	4	10	48	150	16	135
U	055100090	90	105	125	51	5	11	56	240	16	75
U	055100110	110	126	150	61	5	12	66	370	16	48
U	055100125	125	146	169	69	5	11	74	585	16	40
U	055100140	140	163	188	76	6	12	82	735	16	21
U	055100160	160	185	213	86	6	13	92	1000	16	16
	055100200	200	228	254	106	7	17	113	1655	10	8
	055100225	225	249	272	119	8	18	126	1805	10	6

Quality certifications : U = UNI-IIP

### 055200 Stub Serrated Cemented

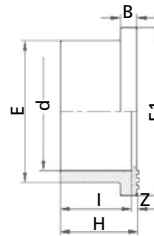

Quality	Cod	d	E	E1	I	Z	B	H	Weight	PN	Pack
U	055200020	20	27	34	16	3	7	19	10	16	2000
U	055200025	25	33	41	19	3	7	22	16	16	1200
U	055200032	32	41	50	22	3	7	25	25	16	850
U	055200040	40	50	61	26	3	8	29	40	16	400
U	055200050	50	61	73	31	3	8	34	60	16	270
U	055200063	63	76	90	38	3	9	41	100	16	160
U	055200075	75	88	106	44	4	10	48	150	16	135
U	055200090	90	105	125	51	5	11	56	240	16	75
U	055200110	110	126	150	61	5	12	66	380	16	48
U	055200125	125	146	169	69	5	11	74	590	16	40
U	055200140	140	163	188	76	6	12	82	735	16	21
U	055200160	160	185	213	86	6	13	92	1000	16	16
	055200200	200	228	254	106	7	19	114	1677	10	8
	055200225	225	249	272	119	8	18	126	1810	10	6
	*055200250	250	273	307	131	10	20	131	2320	10	4
	*055200280	280	308	329	142	10	23	142	3036	10	5
	*055200315	315	346	379	161	11	27	161	4578	10	3

Quality certifications : U = UNI-IIP

\* DELIVERY PROGRAM

**PVC CEMENTED FITTINGS**

**059000  
Loose Flange**

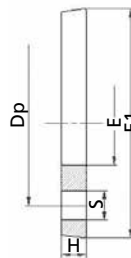

Quality	Cod	d	E	E1	H	Dp	S	N	Weight	PN	Pack
	059000020	20	25	95	12	65	14	4	85	16	450
	059000025	25	32	105	12	75	14	4	120	16	400
U	059000032	32	44	115	14	85	14	4	130	16	180
U	059000040	40	54	140	15	100	18	4	205	16	100
U	059000050	50	65	150	16	110	18	4	235	16	80
U	059000063	63	80	165	18	125	18	4	300	16	75
U	059000075	75	94	185	19	145	18	4	390	16	50
U	059000090	90	112	200	20	160	18	8	460	16	40
U	059000110	110	135	220	22	180	18	8	540	16	30
U	059000125	125	151	230	25	191	18	8	585	16	30
U	059000140	140	164	250	28	211	18	8	746	16	20
U	059000160	160	193	289	30	241	22	8	1050	16	26
	059000200	200	233	340	32	297	22	8	1402	10	12
	059000225	225	243	340	32	295	22	8	1249	10	12
	*059000250	250	280	395	34	350	34	12	1680	10	8
	*059000280	280	310	395	30	350	30	12	2000	10	8
	*059000315	315	349	445	31	400	31	12	2700	10	8

Quality certifications : U = UNI-IIP

\* DELIVERY PROGRAM

**059100  
Blind Flange**

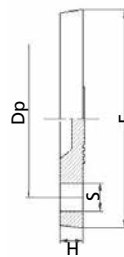

Cod	d	E	H	Dp	S	N	Weight	PN	Pack
059100032	32	115	14	85	14	4	143	16	100
059100040	40	140	15	100	18	4	240	16	100
059100050	50	150	16	110	18	4	286	16	80
059100063	63	165	18	125	18	4	390	16	75
059100075	75	185	19	145	18	4	490	16	50
059100090	90	200	20	160	18	8	640	16	40
059100110	110	220	22	180	18	8	786	16	30
059100125	125	230	25	191	18	8	848	16	25
059100140	140	250	28	211	18	8	1125	16	20
059100160	160	289	30	241	22	8	1743	16	15
059100200	200	340	32	297	22	8	2700	10	12
059100225	225	340	32	297	22	8	2950	10	12



## PVC CEMENTED FITTINGS

### 059200 Fixed Flange

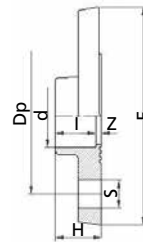

Quality	Cod	d	I	E	H	Dp	S	N	Z	Weight	PN	Pack
U	059200032	32	22	115	23	85	14	4	3	140	16	144
U	059200040	40	26	140	27	100	18	4	3	240	16	70
U	059200050	50	31	150	32	110	18	4	3	290	16	60
U	059200063	63	38	165	39	125	18	4	3	400	16	45
U	059200075	75	44	185	47	145	18	4	4	540	16	25
U	059200090	90	51	200	54	160	18	8	5	710	16	18
U	059200110	110	61	220	64	180	18	8	6	940	16	12

Quality certifications : U = UNI-IIP

**PVC ADAPTOR FITTINGS**

**050102**  
**Socket Adaptor**  
Cemented Threaded

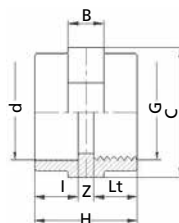

Cod	dxG	C	B	I	Lt	Z	H	Weight	PN	Pack
050102016003	16 x 3/8"	25	12	14	13	3	30	10	16	2300
050102020005	20 x 1/2"	30	12	16	17	3	36	18	16	1400
050102025007	25 x 3/4"	40	12	19	18	3	40	27	16	900
050102032010	32 x 1"	45	12	22	20	3	45	42	16	500
050102040013	40 x 1.1/4"	51	16	26	22	4	52	50	16	300
050102050015	50 x 1.1/2"	63	16	31	22	4	57	100	16	200
050102063020	63 x 2"	80	16	38	26	4	68	150	16	100
050102075025	75 x 2.1/2"	90	20	44	29	5	78	190	16	60
050102090030	90 x 3"	108	24	51	33	5	89	333	16	60
050102110040	110 x 4"	130	28	61	40	5	106	483	16	32

**050202**  
**Reducer Adaptor**  
Male - Female  
Cemented Threaded

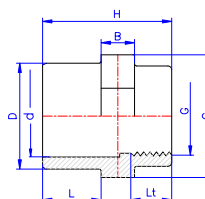

Cod	DxdxG	C	B	L	Lt	H	Weight	PN	Pack
050202025005	25 x 20 x 1/2"	30	12	19	17	46	19	16	1200
050202032007	32 x 25 x 3/4"	36	12	22	18	50	30	16	700
050202040010	40 x 32 x 1"	47	16	26	20	63	60	16	350
050202050013	50 x 40 x 1.1/4"	65	16	31	22	68	111	16	200
050202063013	63 x 50 x 1.1/4"	65	16	38	22	75	135	16	150
050202063015	63 x 50 x 1.1/2"	65	16	38	22	75	135	16	150
050202075020	75 x 63 x 2"	80	20	44	26	83	180	16	120
050202090025	90 x 75 x 2.1/2"	95	20	51	29	94	268	16	80
050202110030	110 x 90 x 3"	120	20	61	33	106	468	16	50

**050302**  
**Adaptor Socket**  
Male - Female  
Cemented Threaded

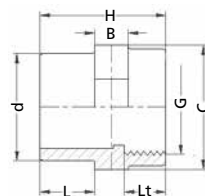

Cod	dxG	C	B	L	Lt	H	Weight	PN	Pack
050302020005	20 x 1/2"	30	12	16	12	40	15	16	1000
050302025007	25 x 3/4"	30	12	19	18	46	24	16	700
050302032010	32 x 1"	36	12	22	20	51	46	16	500
050302040013	40 x 1.1/4"	50	16	26	22	61	61	16	300
050302050015	50 x 1.1/2"	65	16	31	22	64	118	16	200
050302063020	63 x 2"	65	16	38	26	73	148	16	100
050302075025	75 x 2.1/2"	80	20	44	29	87	180	16	90
050302090030	90 x 3"	95	20	51	33	97	328	16	50
050302110040	110 x 4"	120	20	61	40	112	478	16	30

**PVC ADAPTOR FITTINGS**

**050402**  
**90° Tee**  
Cemented Threaded

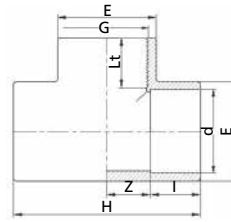

Cod	dxGxd	E	I	Lt	Z	H	Weight	PN	Pack
050402016003	16 x 3/8"	22	14	13	9	46	16	16	1440
050402020005	20 x 1/2"	27	16	17	11	55	24	16	700
050402025007	25 x 3/4"	33	19	18	14	65	39	16	500
050402032010	32 x 1"	41	22	20	17	78	70	16	250
050402040013	40 x 1.1/4"	48	26	22	21	98	121	16	130
050402050015	50 x 1.1/2"	62	31	22	26	118	205	16	80
050402063020	63 x 2"	73	38	26	33	145	400	16	56
050402075025	75 x 2.1/2"	90	44	29	40	170	620	16	35
050402090030	90 x 3"	108	51	33	48	199	1006	16	24
050402110040	110 x 4"	132	61	40	58	229	1620	16	14

**050502**  
**90° Elbow**  
Cemented Threaded

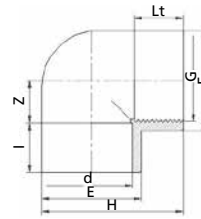

Cod	dxG	E	I	Lt	Z	H	Weight	PN	Pack
050502016003	16 x 3/8"	23	14	13	9	34	10	16	2000
050502020005	20 x 1/2"	20	16	17	11	41	15	16	1000
050502025007	25 x 3/4"	30	19	18	14	49	25	16	600
050502032010	32 x 1"	38	22	20	17	60	45	16	350
050502040013	40 x 1.1/4"	48	26	22	21	74	70	16	200
050502050015	50 x 1.1/2"	62	31	22	26	90	165	16	130
050502063020	63 x 2"	73	38	26	33	111	315	16	60
050502075025	75 x 2.1/2"	90	44	29	40	130	469	16	50
050502090030	90 x 3"	108	51	33	47	154	775	16	32
050502110040	110 x 4"	132	61	40	57	186	1230	16	17

**050602**  
**Adaptor**  
Male - Female  
Cemented - Male Threaded

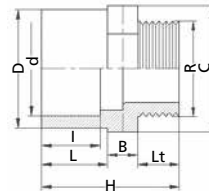

Cod	DxdxR	C	B	I	L	Lt	H	Weight	PN	Pack
050602016003	16 x 12 x 3/8"	22	12	12	14	11	37	10	16	2700
050602020005	20 x 16 x 1/2"	24	12	14	16	16	44	18	16	2000
050602025007	25 x 20 x 3/4"	30	12	16	19	17	48	27	16	1200
050602032010	32 x 25 x 1"	36	12	19	22	19	55	29	16	700
050602040013	40 x 32 x 1.1/4"	46	16	22	26	22	64	64	16	400
050602050015	50 x 40 x 1.1/2"	50	16	26	31	22	69	103	16	220
050602063020	63 x 50 x 2"	65	16	31	38	26	80	167	16	140
050602075025	75 x 63 x 2.1/2"	76	12	38	44	29	85	158	16	125
050602090030	90 x 75 x 3"	95	20	44	51	33	104	329	16	75
050602110040	110 x 90 x 4"	120	20	51	61	41	122	483	16	32

**PVC ADAPTOR FITTINGS**

**050802**  
**Union Adaptor**  
Female - Cemented  
Threaded

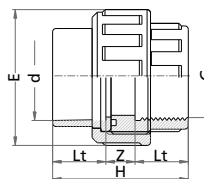

Cod	dxG	E	I	Lt	Z	H	Weight	PN	Pack
050802016003	16 x 3/8"	34	14	13	13	39	22	16	1000
050802020005	20 x 1/2"	42	16	17	12	46	39	16	580
050802025007	25 x 3/4"	52	19	18	15	51	63	16	400
050802032010	32 x 1"	59	22	20	17	57	87	16	250
050802040013	40 x 1.1/4"	72	26	24	16	66	140	16	150
050802050015	50 x 1.1/2"	79	31	24	17	72	190	16	100
050802063020	63 x 2"	96	38	34	20	92	334	16	60
050802075025	75 x 2.1/2"	118	44	29	50	110	566	10	45
050802090030	90 x 3"	132	51	33	59	125	730	10	30
050802110040	110 x 4"	151	61	40	63	145	1213	10	18

**052102**  
**Adaptor**  
Male - Female - Cemented  
Male - Threaded

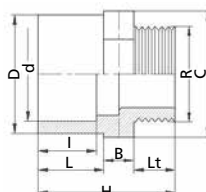

Cod	DxdxR	C	B	I	L	Lt	H	Weight	PN	Pack
052102016003	20 x 16 x 3/8"	22	12	14	16	11	40	10	16	2500
052102020005	25 x 20 x 1/2"	30	12	16	19	16	47	17	16	1300
052102025007	32 x 25 x 3/4"	36	12	19	22	17	51	27	16	800
052102032010	40 x 32 x 1"	46,5	16	22	26	19	62	53	16	450
052102040013	50 x 40 x 1.1/4"	50	16	26	31	22	70	70	16	250
052102050015	63 x 50 x 1.1/2"	65	16	31	38	22	76	140	16	170
052102063020	75 x 63 x 2"	76	12	38	44	26	82	158	16	120
052102075025	90 x 75 x 2.1/2"	95	20	44	51	30	101	310	16	60
052102090030	110 x 90 x 3"	120	20	51	61	33	114	550	16	50
052102110040	125 x 110 x 4"	130	20	61	69	41	130	590	16	30

**052202**  
**Bushing Adaptor**  
Male - Female - Cemented  
Male - Threaded

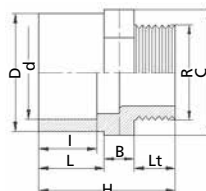

Cod	DxdxR	C	B	I	L	L1	H	Weight	PN	Pack
052202020003	25 x 20 x 3/8"	30	12	16	19	11	42	15	16	1400
052202025005	32 x 25 x 1/2"	36	12	19	22	16	50	25	16	900
052202032007	40 x 32 x 3/4"	46	16	22	26	17	59	51	16	450
052202040010	50 x 40 x 1"	50	16	26	31	19	66	97	16	200
052202050013	63 x 50 x 1.1/4"	65	16	31	38	22	76	135	16	170
052202063015	75 x 63 x 1.1/2"	76	12	38	44	22	78	153	16	154
052202075020	90 x 75 x 2"	95	20	44	51	26	97	285	16	60
052202090025	110 x 90 x 2.1/2"	120	20	51	61	30	111	528	16	50
052202110030	125 x 110 x 3"	130	20	61	69	33	122	545	16	42

**PVC ADAPTOR FITTINGS**

**053602  
House Adaptor  
With Threaded Nut**

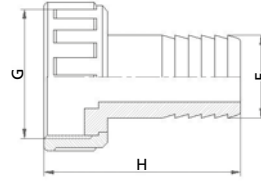

Cod	GxE	E	H	Weight	PN	Pack
053602016007	3/4" x 16	16	67	21	10	1000
053602020010	1" x 20	20	72	32	10	700
053602025013	1.1/4" x 25	25	80	54	10	400
053602030015	1.1/2" x 30	30	91	69	10	250
053602040020	2" x 40	40	97	124	10	150
053602050023	2.1/4" x 50	50	104	186	10	120
053602060027	2.3/4" x 60	60	118	260	10	70

**054502  
45° Elbow  
Cemented - Threaded**

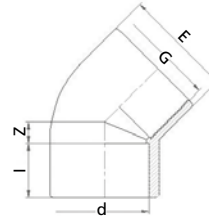

Cod	dxG	E	Z	I	Weight	PN	Pack
054502016003	16 x 3/8"	23	5	14	13	16	1800
054502020005	20 x 1/2"	26	5	16	15	16	1400
054502025007	25 x 3/4"	31	6	19	24	16	850
054502032010	32 x 1"	39	8	22	42	16	450
054502040013	40 x 1.1/4"	48	10	26	70	16	250
054502050015	50 x 1.1/2"	59	12	31	121	16	120
054502063020	63 x 2"	74	15	38	230	16	80

**051402  
90° Reducing Tee  
Cemented - Threaded**

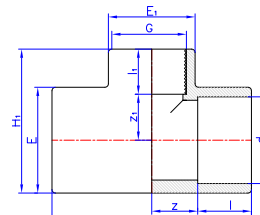

Cod	dxGxd	E	E1	I	I1	Z	Z1	H	H1	Weight	PN	Pack
051402025005	25 x 1/2" x 25	33	27	19	16	14	12.5	66	45	36	16	500
051402032005	32 x 1/2" x 32	42	33	22	16	17	27.5	78	54	69	16	300
051402032007	32 x 3/4" x 32	41	33	22	19	17	17.5	78	57	63	16	300
051402040005	40 x 1/2" x 40	50	30	26	16	23.5	22	99	63	104	16	180
051402040007	40 x 3/4" x 40	50	37	26	24	23.5	22	99	66	110	16	160
051402040010	40 x 1" x 40	50	44	26	22	23.5	22	99	72	120	16	150
051402050007	50 x 3/4" x 50	62	37	31	24	28	27.5	118	77	188	16	80
051402050010	50 x 1" x 50	61	41	31	22	28	27.5	118	80	190	16	80
051402050013	50 x 1.1/4" x 50	61	50	31	26	28	27.5	118	84	180	16	80
051402063010	63 x 1" x 63	77	41	38	22	34	34.5	144	95	335	16	56
051402063013	63 x 1.1/4 x 63	77	50	38	26	34	34.5	144	99	340	16	56
051402063015	63 x 1.1/2" x 63	77	61	38	31	34	34.5	144	104	350	16	56

**PVC ADAPTOR FITTINGS**

**057102**  
**Socket Adaptor**  
Cemented - Threaded  
with Reinforcing Ring

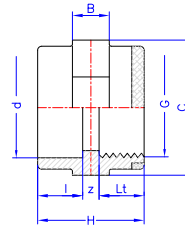

Cod	dxG	C	B	I	Lt	Z	H	Weight	PN	Pack
057102016003	16 x 3/8"	25	12	14	13	3	30	10	16	2300
057102020005	20 x 1/2"	30	12	16	17	3	36	18	16	1400
057102025007	25 x 3/4"	40	12	19	18	3	40	27	16	900
057102032010	32 x 1"	45	12	22	20	3	45	42	16	500
057102040013	40 x 1.1/4"	51	16	26	22	4	52	50	16	300
057102050015	50 x 1.1/2"	63	16	31	22	4	57	100	16	200
057102063020	63 x 2"	80	16	38	26	4	68	150	16	100

**057202**  
**Reducer Adaptor**  
with Reinforcing  
Ring  
Male - Cemented  
Female - Threaded

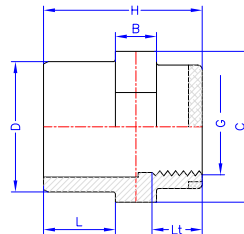

Cod	DxdxG	C	B	L	Lt	H	Weight	PN	Pack
057202025005	25 x 20 x 1/2"	30	12	19	17	46	19	16	1200
057202032007	32 x 25 x 3/4"	36	12	22	18	50	30	16	700
057202040010	40 x 32 x 1"	47	16	26	20	63	60	16	350
057202050013	50 x 40 x 1.1/4"	65	16	31	22	68	111	16	200
057202063013	63 x 50 x 1.1/4"	65	16	38	22	75	135	16	150
057202063015	63 x 50 x 1.1/2"	65	16	38	22	75	135	16	150

**PVC ADAPTOR FITTINGS**

**057402**  
**90° Tee**  
**with Reinforcing**  
**Ring**  
 Cemented - Threaded

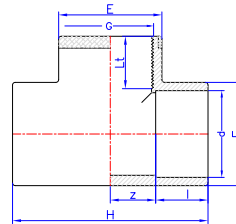

Cod	dxGxd	E	I	Lt	Z	H	Weight	PN	Pack
057402016003	16 x 3/8"	22	14	13	9	46	16	16	1440
057402020005	20 x 1/2"	27	16	17	11	55	24	16	700
057402025007	25 x 3/4"	33	19	18	14	65	39	16	500
057402032010	32 x 1"	41	22	20	17	78	70	16	250
057402040013	40 x 1.1/4"	48	26	22	21	98	121	16	130
057402050015	50 x 1.1/2"	62	31	22	26	118	205	16	80
057402063020	63 x 2"	73	38	26	33	145	400	16	56

**057502**  
**90° Elbow**  
**with Reinforcing**  
**Ring**  
 Cemented - Threaded

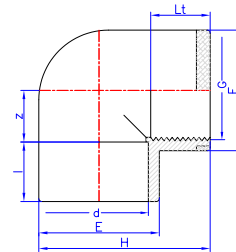

Cod	dxG	E	I	Lt	Z	H	Weight	PN	Pack
057502016003	16 x 3/8"	23	14	13	9	34	10	16	2000
057502020005	20 x 1/2"	20	16	17	11	41	15	16	1000
057502025007	25 x 3/4"	30	19	18	14	49	25	16	600
057502032010	32 x 1"	38	22	20	17	60	45	16	350
057502040013	40 x 1.1/4"	48	26	22	21	74	70	16	200
057502050015	50 x 1.1/2"	62	31	22	26	90	165	16	130
057502063020	63 x 2"	73	38	26	33	111	315	16	60

**PVC ADAPTOR FITTINGS**

**058900**  
**Metal Pipe & Tap**  
**Connectors, with**  
**EPDM gaskets and PVC**  
**Spigot x brass nuts**  
**Female - Threaded**

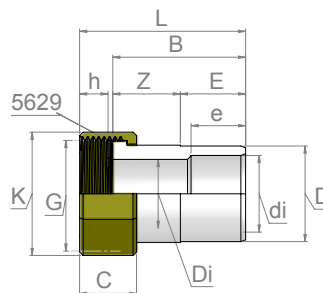

Cod	D	di	G	E	e	Z	B	L	Di	K	C	5629	h	Weight	PN	Pack
05890025010	25	20	1"	18,5	17	24	42,5	54	17	36	20	30 x 21 x 2	9,5	74	10	310
05890032013	32	25	1¼"	22	20	25,5	48	60	20	45	22	38 x 27 x 2	10,5	120	10	200
05890040015	40	32	1½"	27	22,5	28,5	55	69	29	52	24	44 x 32 x 2	12	166	10	140
05890050020	50	40	2"	32	27	30	62	77	35	64	26	62 x 46 x 2	13	250	10	95

**058100**  
**Metal Pipe & Tap**  
**Connectors, with**  
**EPDM gaskets and PVC**  
**Socket x brass nuts**  
**Female - Threaded**

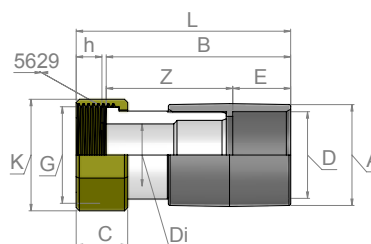

Cod	A	D	G	E	Z	B	L	Di	K	C	5629	h	Weight	PN	Pack
058100025010	30	25	1"	19	46	65	76,5	17	37	20	30 x 21 x 2	9,5	86	10	250
058100032013	38	32	1¼"	22	51,5	73,5	86	20	46	22	38 x 27 x 2	10,5	140	10	150
058100040015	48	40	1½"	27	58	85	100	29	53	24	44 x 32 x 2	12,5	211	10	100



**PVC ADAPTOR FITTINGS**

**058200**  
**Metal Pipe & Tap**  
**Connectors, with**  
**EPDM gaskets and PVC**  
**Socket x brass nuts**  
**Female - Threaded**

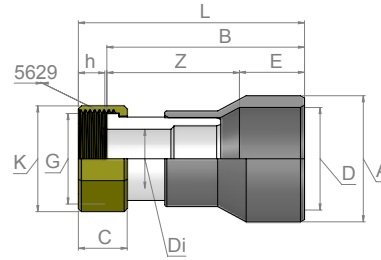

Cod	A	D	G	E	Z	B	L	Di	K	C	5629	h	Weight	PN	Pack
058200025007	32	25	¾"	19	47	66	77	14	30	18	24 x 16 x 2	8	66	10	300
058200032010	40	32	1"	22	50	72	82,5	17	37	20	30 x 21 x 2	9,5	100	10	200
058200040013	50	40	1¼"	26	65	91	103,5	20,5	46	22	38 x 27 x 2	11	174	10	130
058200050015	63	50	1½"	31	78	109	122	29	53	24	44 x 32 x 2	12	266	10	75
058200063020	75	63	2"	39	85	124	138,5	35	64	26	62 x 46 x 2	13	394	10	50

**058901**  
**Metal Pipe & Tap**  
**Connectors, with**  
**EPDM gaskets and PVC**  
**Spigot x brass nuts**  
**Female - Threaded**

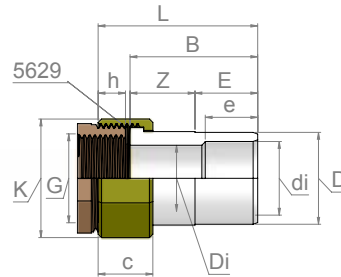

Cod	D	di	G	E	e	Z	B	L	Di	K	C	5629	h	Weight	PN	Pack
058901025007	25	20	¾"	19	16	24	43	54,5	17	30	20	30 x 21 x 2	9,5	124	10	180
058901032010	32	25	1"	22	19	25,5	48	60	20,5	45	22	38 x 27 x 2	10,5	224	10	110
058901040013	40	32	1¼"	26	22	28	55	63	29	53	24	44 x 32 x 2	12	276	10	90

**PVC THREADED FITTINGS**

**050101**  
**Socket - Threaded**

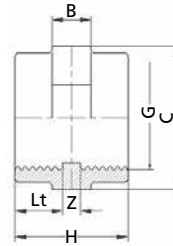

Cod	G	C	B	Lt	Z	H	Weight	PN	Pack
050101003	3/8"	25	12	13	4	30	10	16	2300
050101005	1/2"	30	12	17	2	36	16	16	1400
050101007	3/4"	40	12	18	4	40	28	16	900
050101010	1"	45	12	20	5	45	39	16	500
050101013	1.1/4"	51	16	22	8	52	55	16	300
050101015	1.1/2"	63	16	22	13	57	112	16	200
050101020	2"	80	16	26	16	68	166	16	100
050101025	2.1/2"	90	20	29	20	78	200	16	60
050101030	3"	108	24	33	23	89	310	16	60
050101040	4"	130	28	40	26	106	450	16	32

**050103**  
**Socket - Threaded**  
**Female - Female**

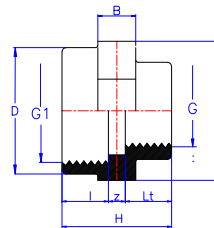

Cod	GxG1	C	B	I	Lt	Z	H	Weight	PN	Pack
050103007005	1/2" x 3/4"	40	12	13	14	3	38,3	27	16	600
050103010007	1" x 3/4"	45	12	14	17	3	42,21	37	16	500

## PVC THREADED FITTINGS

### 050201

#### Reducer

Male - Female - Threaded

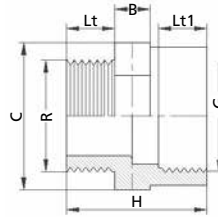

Cod	RXG	C	B	Lt	Lt1	H	Weight	PN	Pack
050201005003	1/2" x 3/8"	30	12	13	17	40	17	16	1600
050201007003	3/4" x 3/8"	36	12	13	18	41	18	16	1400
050201007005	3/4" x 1/2"	36	12	17	18	45	21	16	1100
050201010003	1" x 3/8"	40	10	11	19	41	20	16	900
050201010005	1" x 1/2"	40	12	22	11	46	33	16	900
050201010007	1" x 3/4"	36	12	18	20	48	30	16	800
050201013005	1.1/4" x 1/2"	46	16	17	22	53	52	16	450
050201013007	1.1/4" x 3/4"	46	16	18	22	54	52	16	450
050201013010	1.1/4" x 1"	55	16	24	22	58	71	16	350
050201015005	1.1/2" x 1/2"	50	16	22	15	52	59	16	340
050201015007	1.1/2" x 3/4"	50	16	18	22	54	61	16	340
050201015010	1.1/2" x 1"	50	16	20	22	59	99	16	340
050201015013	1.1/2" x 1.1/4"	55	16	23	24	58	74	16	300
050201020007	2" x 3/4"	70	18	16	26	60	80	16	200
050201020010	2" x 1"	65	16	20	26	62	105	16	200
050201020013	2" x 1.1/4"	65	16	22	26	63	109	16	200
050201020015	2" x 1.1/2"	65	16	22	26	63	109	16	200
050201025015	2.1/2" x 1.1/2"	80	20	22	29	66	163	16	168
050201025020	2.1/2" x 2"	80	20	26	29	68	170	16	80
050201030020	3" x 2"	95	20	34	19	72	245	16	120
050201030025	3" x 2.1/2"	95	20	29	33	76	254	16	110
050201040025	4" x 2.1/2"	120	20	29	40	87	400	16	57
050201040030	4" x 3"	120	20	42	25	86	406	16	57

### 050401

#### 90° Tee - Threaded

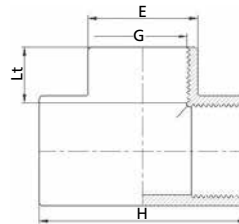

Cod	G	E	Lt	H	Weight	PN	Pack
050401003	3/8"	22	13	46	16	16	1500
050401005	1/2"	28	17	55	29	16	700
050401007	3/4"	33	18	65	40	16	500
050401010	1"	42	24	78	77	16	250
050401013	1.1/4"	48	22	98	120	16	130
050401015	1.1/2"	62	22	118	240	16	80
050401020	2"	73	26	145	480	16	56
050401025	2.1/2"	90	29	170	644	16	35
050401030	3"	108	33	199	1100	16	24
050401040	4"	132	40	239	1625	16	14

**PVC THREADED FITTINGS**

**050501**  
**90° Elbow - Threaded**

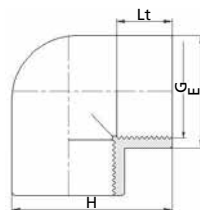

Cod	G	E	Lt	H	Weight	PN	Pack
050501003	3/8"	23	13	35	10	16	1800
050501005	1/2"	20	17	42	15	16	1000
050501007	3/4"	30	18	50	25	16	600
050501010	1"	38	20	60	45	16	350
050501013	1.1/4"	48	22	75	90	16	200
050501015	1.1/2"	62	22	90	180	16	130
050501020	2"	73	26	111	355	16	60
050501025	2.1/2"	90	29	130	508	16	50
050501030	3"	108	33	154	861	16	30
050501040	4"	132	40	186	1225	16	17

**050601**  
**Nipple - Threaded**

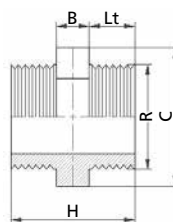

Cod	R	C	B	Lt	H	Weight	PN	Pack
050601003	3/8"	22	12	11	35	10	16	2800
050601005	1/2"	24	12	16	45	13	16	2000
050601007	3/4"	30	12	17	47	20	16	1300
050601010	1"	36	12	19	51	30	16	700
050601013	1.1/4"	46	16	22	60	56	16	400
050601015	1.1/2"	50	16	22	60	65	16	300
050601020	2"	65	16	26	68	107	16	150
050601025	2.1/2"	80	20	30	80	190	16	96
050601030	3"	95	20	33	87	268	16	85
050601040	4"	120	20	41	102	520	16	42

**050701**  
**Cap - Threaded**

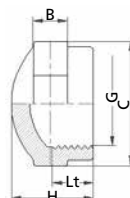

Cod	G	C	B	Lt	H	Weight	PN	Pack
050701003	3/8"	25	12	16	25	10	16	2600
050701005	1/2"	30	12	19	27	16	16	1400
050701007	3/4"	40	12	18	30	26	16	1100
050701010	1"	45	12	22	32	30	16	530
050701013	1.1/4"	52	12	22	33	42	16	300
050701015	1.1/2"	58	12	24	38	62	16	300
050701020	2"	75	12	22	45	117	16	160
050701025	2.1/2"	95	20	32	51	205	16	70
050701030	3"	110	20	32	51	274	16	80
050701040	4"	130	20	35	63	453	16	56

**PVC THREADED FITTINGS**

**050801  
Union Female  
Threaded**

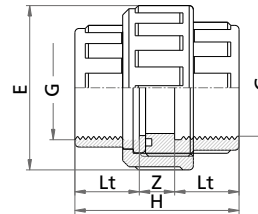

Cod	G	E	Lt	Z	H	Weight	PN	Pack
050801003	3/8"	34	13	13	39	22	16	1000
050801005	1/2"	42	17	12	46	49	16	580
050801007	3/4"	52	18	15	51	65	16	400
050801010	1"	59	20	17	57	90	16	250
050801013	1.1/4"	72	24	18	66	140	16	150
050801015	1.1/2"	79	24	24	72	190	16	100
050801020	2"	96	34	24	92	350	16	60
050801025	2.1/2"	118	30	50	110	570	10	45
050801030	3"	132	33	59	125	740	10	30
050801040	4"	151	41	63	145	1220	10	18

**050803  
Union  
Male - Female  
Cemented - Threaded**

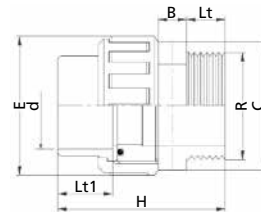

Cod	dxR	Lt	Lt1	E	H	C	B	Weight	PN	Pack
050803025007	25 x 3/4"	17	19	51	66	40	12	79	16	350
050803032010	32 x 1"	22	22	58	73	45	13	109	16	250
050803040013	40 x 1.1/4"	25	22	72	90	55	16	187	16	150
050803050015	50 x 1.1/2"	22	31	79	79	50	16	180	16	100
050803063020	63 x 2"	26	38	96	93	65	16	310	16	60

**050804  
Union  
Male - Female  
Threaded**

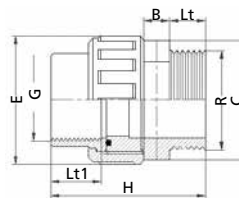

Cod	GxR	Lt	Lt1	E	H	C	B	Weight	PN	Pack
050804007	3/4" x 3/4"	17	19	51	66	40	12	79	16	350
050804010	1" x 1"	22	22	58	73	45	13	109	16	250
050804013	1.1/4" x 1.1/4"	22	22	72	67	46	16	135	16	150
050804015	1.1/2" x 1.1/2"	22	22	79	79	50	16	180	16	100
050804020	2" x 2"	26	26	96	93	65	16	310	16	60

**PVC THREADED FITTINGS**

**051601  
Reducing Nipple  
Threaded**

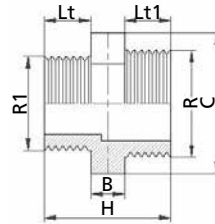

Cod	RxR1	C	B	Lt	Lt1	H	Weight	PN	Pack
051601005003	1/2" x 3/8"	24	12	16	11	39	11	16	2200
051601007003	3/4" x 3/8"	30	12	17	16	45	18	16	1400
051601007005	3/4" x 1/2"	30	12	17	11	40	17	16	1300
051601010005	1" x 1/2"	38	12	19	17	46	27	16	900
051601010007	1" x 3/4"	36	12	19	16	45	26	16	800
051601013007	1.1/4" x 3/4"	50	16	22	19	57	57	16	400
051601013010	1.1/4" x 1"	50	16	22	17	55	54	16	350
051601015010	1.1/2" x 1"	50	16	22	22	56	59	16	350
051601015013	1.1/2" x 1.1/4"	50	16	22	22	60	60	16	300
051601020013	2" x 1.1/4"	65	16	26	22	64	104	16	200
051601020015	2" x 1.1/2"	65	16	26	22	64	97	16	180
051601025015	2.1/2" x 1.1/2"	80	20	30	22	72	170	16	164
051601025020	2.1/2" x 2"	80	20	30	26	76	176	16	164
051601030020	3" x 2"	90	20	33	30	83	265	16	75
051601030025	3" x 2.1/2"	90	20	33	26	79	251	16	70
051601040025	4" x 2.1/2"	120	20	41	33	94	435	16	70
051601040030	4" x 3"	120	20	41	30	91	422	16	70

## PVC THREADED FITTINGS

### 051701 Plug - Threaded

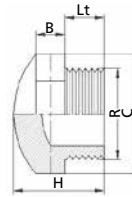

Cod	R	C	B	Lt	H	Weight	PN	Pack
051701003	3/8"	22	12	13	25	7	16	3000
051701005	1/2"	24	12	17	30	12	16	2500
051701007	3/4"	30	12	18	32	16	16	1500
051701010	1"	36	12	20	35	24	16	1100
051701013	1.1/4"	46	16	22	43	47	16	500
051701015	1.1/2"	51	16	22	44	57	16	480
051701020	2"	65	16	26	48	97	16	250
051701025	2.1/2"	80	20	30	56	160	16	82
051701030	3"	95	20	33	61	263	16	70
051701040	4"	120	20	40	71	425	16	72

### 053601 House Adaptor Threaded

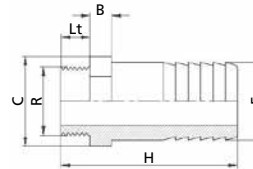

Cod	RxE	C	B	Lt	H	Weight	PN	Pack
053601012004	1/4" x 12	16	12	11	49	6	16	5600
053601016003	3/8" x 16	22	12	13	58	12	16	2200
053601020005	1/2" x 20	26	12	16	64	18	16	1600
053601025007	3/4" x 25	30	12	17	72	30	16	1000
053601030010	1" x 30	36	16	19	84	38	16	560
053601040013	1.1/4" x 40	46	16	22	91	70	16	280
053601050015	1.1/2" x 50	50	16	22	94	107	16	200
053601060020	2" x 60	65	16	26	118	150	16	120

### 052201 Nipple Socket Male - Female - Threaded

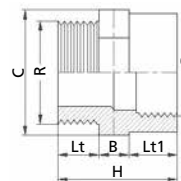

Cod	RxG	C	B	Lt	Lt1	H	Weight	PN	Pack
052201003005	3/8" x 1/2"	30	12	17	11	40	18	16	1100
052201005007	1/2" x 3/4"	36	12	18	16	44	25	16	900
052201007010	3/4" x 1"	46	16	20	17	45	40	16	600
052201010013	1" x 1.1/4"	55	16	22	18	57	68	16	300
052201013015	1.1/4" x 1.1/2"	65	16	24	20	61	109	16	250
052201015020	1.1/2" x 2"	80	16	26	24	66	169	16	150
052201015025	1.1/2" x 2.1/2"	80	20	29	22	65	200	16	170
052201020025	2" x 2.1/2"	95	20	29	26	69	210	16	170
052201020030	2" x 3"	95	20	33	26	70	320	16	85
052201025030	2.1/2" x 3"	120	20	33	30	74	340	16	70
052201025040	2.1/2" x 4"	120	20	40	30	82	410	16	70
052201030040	3" x 4"	130	20	40	33	87	430	16	70

**PVC THREADED FITTINGS**

**054501**  
**45° Elbow**  
Threaded

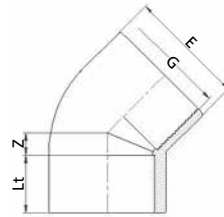

Cod	G	E	Z	Lt	Weight	PN	Pack
054501005	1/2"	26	5	17	15	16	1400
054501007	3/4"	31	6	18	24	16	850
054501010	1"	39	8	20	42	16	450
054501013	1.1/4"	48	10	22	70	16	250
054501015	1.1/2"	59	12	22	121	16	120
054501020	2"	74	15	26	230	16	80

**059201**  
**Fixed Flange**  
Threaded

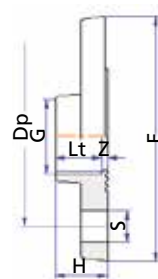

Cod	G	Lt	E	H	Dp	S	N	Z	Weight	PN	Pack
059201010	1"	20	115	23	85	14	4	3	148	16	144
059201013	1.1/4"	22	140	27	100	18	4	5	225	16	70
059201015	1.1/2"	22	150	32	110	18	4	10	276	16	60
059201020	2"	26	165	39	125	18	4	13	380	16	45
059201025	2.1/2"	29	185	47	145	18	4	18	659	16	25
059201030	3"	33	200	54	160	18	8	21	670	16	18
059201040	4"	40	220	64	180	18	8	24	900	16	12



## PVC FITTINGS ACCESSORIES

### 054800

#### Nut for Unions:

050800, 050801, 050802,  
050803, 050804, 053602

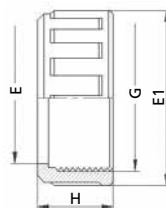

Cod	d	G	E	E1	H	Weight	PN
054800016	16	3/4"	22	34	20	10	16
054800020	20	1"	27	42	23	18	16
054800025	25	1.1/4"	36	52	25	27	16
054800032	32	1.1/2"	41	59	27	35	16
054800040	40	2"	53	72	30	53	16
054800050	50	2.1/4"	57	79	34	70	16
054800063	63	2.3/4"	74	96	38	110	16
054800075	75	3.1/2"	93	118	46	190	10
054800090	90	4"	107	132	53	250	10
054800110	110	5"	125	151	59	430	10

### 055800

#### Bushing for Union:

050800

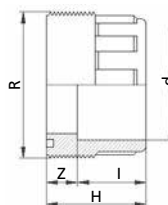

Cod	d	R	I	Z	H	Weight	PN
055800016	16	3/4"	14	9	23	10	16
055800020	20	1"	16	10	26	14	16
055800025	25	1.1/4"	19	10	29	20	16
055800032	32	1.1/2"	22	10	32	34	16
055800040	40	2"	26	12	38	61	16
055800050	50	2.1/4"	31	14	45	81	16
055800063	63	2.3/4"	38	14	52	132	16
055800075	75	3.1/2"	44	18	62	205	10
055800090	90	4"	51	18	69	296	10
055800110	110	5"	61	18	79	473	10

### 055801

#### Bushing for Unions:

050801, 050802

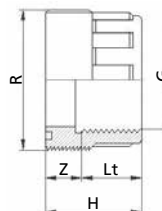

Cod	G	R	Lt	Z	H	PN	Weight
055801003	3/8"	3/4"	13	9	23	16	10
055801005	1/2"	1"	17	10	26	16	17
055801007	3/4"	1.1/4"	18	11	29	16	24
055801010	1"	1.1/2"	20	12	32	16	34
055801013	1.1/4"	2"	22	16	38	16	65
055801015	1.1/2"	2.1/4"	22	23	45	16	95
055801020	2"	2.3/4"	26	26	52	16	170
055801025	2.1/2"	3.1/2"	29	33	62	10	241
055801030	3"	4"	33	36	69	10	300
055801040	4"	5"	40	39	79	10	475

**PVC FITTINGS ACCESSORIES**

**055803**  
**Mail Threaded**  
**Union bush** for items  
 050803, 050804

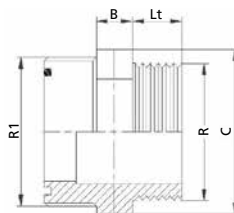

Cod	R	R1	Lt	C	B	Weight	PN
055803007	3/4"	1.1/4"	17	40	12	20	16
055803010	1"	1.1/2"	22	45	13	34	16
055803013	1.1/4"	2"	22	46	16	61	16
055803015	1.1/2"	2.1/4"	22	50	16	81	16
055803020	2"	2.3/4"	26	65	16	132	16

**056800**  
**End for Unions:**  
 050800, 050802, 050803

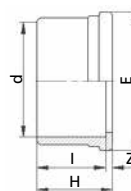

Cod	d	I	Z	E	H	Weight	PN
05680016	16	14	2	24	16	10	16
05680020	20	16	3	30	19	14	16
05680025	25	19	3	39	22	20	16
05680032	32	22	3	44	25	34	16
05680040	40	26	3	55	29	61	16
05680050	50	31	3	62	34	81	16
05680063	63	38	3	78	41	132	16
05680075	75	44	4	97	48	205	10
05680090	90	51	5	110	56	296	10
05680110	110	61	5	135	66	473	10

**056810**  
**End for Unions:**  
 050801, 050804

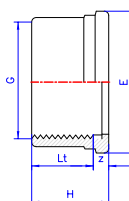

Cod	G	Lt	Z	E	H	Weight	PN
05681003	3/8"	13	3	24	16	5	16
05681005	1/2"	17	3	30	20	10	16
05681007	3/4"	18	4	39	22	16	16
05681010	1"	20	5	44	25	23	16
05681018	1.1/4"	22	7	55	29	36	16
05681015	1.1/2"	22	12	62	34	60	16
05681020	2"	26	15	78	41	105	16
05681025	2.1/2"	29	19	97	48	135	10
05681030	3"	33	23	110	56	180	10
05681040	4"	40	26	135	66	310	10

**PVC FITTINGS ACCESSORIES**

**056090**  
**O-Ring for Item**  
055000

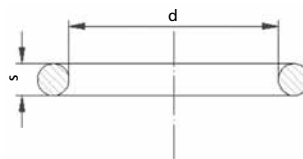
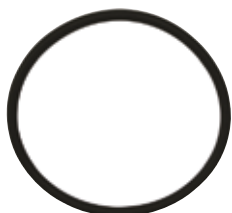

Cod	d	d	s
05609025	16 - 3/8"	28,17	3,53
05609032	20 - 1/2"	36,1	3,53
05609040	25 - 3/4"	40,65	5,34
05609050	32 - 1"	50,16	5,34
05609063	40 - 1.1/4"	66,04	5,34
6325	50 - 1.1/2"	81,92	5,34
05609090	63 - 2"	100,97	5,34
05609110	75 - 2.1/2"	116,84	6,99
05609125	90 - 3"	135,9	6,99
05609140	110 - 4"	151,77	6,99
05609160	63 - 2"	177,17	6,99
05609200	110 - 4"	215,27	6,99
05609225	63 - 2"	240,67	6,99

**056290**  
**Seal for:**  
055200, 053602

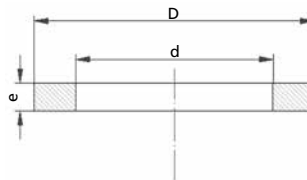

Cod	∅	d	D	e
05629016	16	17	24	2
05629020	20	21	30	2
05629025	25	27	38	2
05629032	32	32	44	2
05629040	40	42	55	2
05629050	50	46	62	2
05629063	63	63	88	2
05629075	75	75	104	2
05629090	90	90	123	2
05629110	110	110	148	3
05629125	125	125	166	3
05629140	140	140	186	3
05629160	160	160	211	3
05629200	200	200	245	3
05629225	225	225	270	3

**PVC FITTINGS ACCESSORIES**

**056390  
O-Ring for Unions**

050800, 050801, 050802,  
050803, 050804

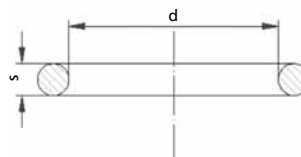
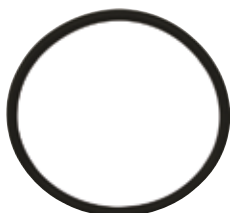

Cod	d	d	s
05639016	16 - 3/8"	16	2.62
05639020	20 - 1/2"	19	3.53
05639025	25 - 3/4"	27	3.53
05639032	32 - 1"	30	3.53
05639040	40 - 1.1/4"	44	3.53
05639050	50 - 1.1/2"	50	3.53
05639063	63 - 2"	59.7	5.34
*05630063	63 - 2"	60	3.53
05639075	75 - 2.1/2"	72	5.34
05639090	90 - 3"	91	5.34
05639110	110 - 4"	100	5.34

\* O-Ring for Unions: 5083, 5084

**VALVES**

**Normal Support**

**111500**  
**Two Nut Valve**  
Cemented

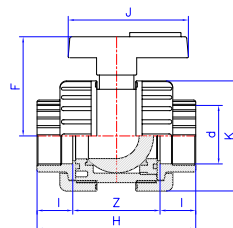

Cod	d	l	Z	H	F	J	K	DN	Weight	PN	Pack
11150016	16	14	43	71	45	65	45	10	93	16	160
11150020	20	16	43	75	45	65	45	15	103	16	160
11150025	25	19	51	89	54	73	55	20	201	16	90
11150032	32	22	58	102	66	78	66	25	281	16	50
11150040	40	26	68	120	74	96	80	32	475	16	40
11150050	50	31	80	142	86	110	96	40	672	16	28
11150063	63	38	93	169	106	129	118	50	1434	16	13

**111510**  
**Two Nut Valve**  
Threaded

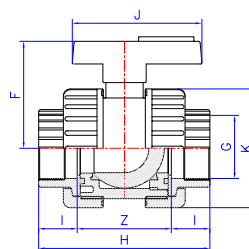

Cod	G	Lt	Z	H	F	J	K	DN	Weight	PN	Pack
11151003	3/8"	12	47	71	45	65	45	10	95	16	160
11151005	1/2"	15	45	75	45	65	45	15	105	16	160
11151007	3/4"	16	57	89	54	73	55	20	204	16	90
11151010	1"	19	64	102	66	78	66	25	284	16	50
11151013	1.1/4"	22	76	120	74	96	80	32	479	16	40
11151015	1.1/2"	22	98	142	86	110	96	40	681	16	28
11151020	2"	26	117	169	106	129	118	50	1439	16	13

**VALVES**

**Normal Support**

**113500**  
**One Nut Valve**  
Cemented

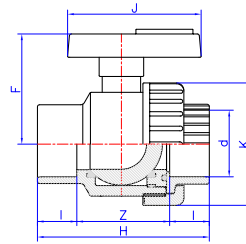

Cod	d	DN	I	Z	J	H	F	K	Weight	PN	Pack
11350016	16	10	14	41	69	45	65	45	85	16	200
11350020	20	15	16	41	73	45	65	45	90	16	200
11350025	25	20	19	49	87	54	73	55	159	16	110
11350032	32	25	22	55	99	66	78	66	222	16	60
11350040	40	32	26	64	116	74	96	80	376	16	45
11350050	50	40	31	76	138	86	110	96	536	16	25
11350063	63	50	38	90	166	106	129	118	1109	16	15

**113510**  
**One Nut Valve**  
Threaded

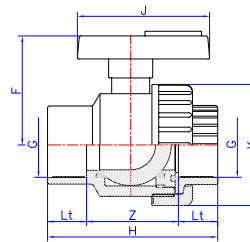

Cod	G	DN	I	Z	J	H	F	K	Weight	PN	Pack
11351003	3/8"	10	14	41	69	45	65	45	85	16	200
11351005	1/2"	15	16	41	73	45	65	45	90	16	200
11351007	3/4"	20	19	49	87	54	73	55	159	16	110
11351010	1"	25	22	55	99	66	78	66	222	16	60
11351013	1.1/4"	32	26	64	116	74	96	80	376	16	45
11351015	1.1/2"	40	31	76	138	86	110	96	536	16	25
11351020	2"	50	38	90	166	106	129	118	1109	16	15

**113610**  
**One Nut Valve**  
Male-Female-Threaded

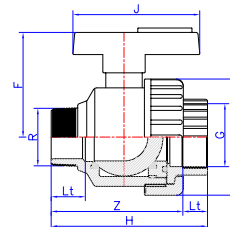

Cod	RxG	Lt	Z	H	F	J	K	DN	Weight	PN	Pack
11361003	3/8"	12	55	67	45	65	45	10	76	16	200
11361005	1/2"	15	57	72	45	65	45	15	82	16	200
11361007	3/4"	16	68	84	54	73	55	20	150	16	110
11361010	1"	19	79	98	66	78	66	25	214	16	60
11361013	1.1/4"	22	90	112	74	96	80	32	359	16	45
11361015	1.1/2"	22	108	130	86	110	96	40	504	16	25
11361020	2"	26	133	159	106	129	118	50	1086	16	15

**VALVES**

**Threaded Support**

**111400**  
**Two Nut Valve**  
Cemented

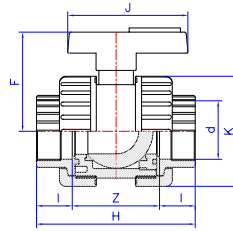

Cod	d	l	Z	H	F	J	K	DN	Weight	PN	Pack
11140016	16	14	43	71	45	65	45	10	93	16	160
11140020	20	16	43	75	45	65	45	15	103	16	160
11140025	25	19	51	89	54	73	55	20	201	16	90
11140032	32	22	58	102	66	78	66	25	281	16	50
11140040	40	26	68	120	74	96	80	32	475	16	40
11140050	50	31	80	142	86	110	96	40	672	16	28
11140063	63	38	93	169	106	129	118	50	1434	16	13
11140075	75	44	137	215	128	132	139	65	2000	10	4
11140090	90	51	148	250	146	153	165	80	3250	10	2
11140110	110	61	173	295	173	185	207	100	6300	10	2

**111410**  
**Two Nut Valve**  
Threaded

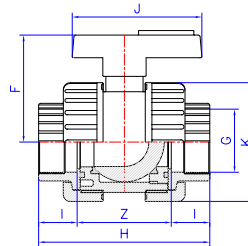

Cod	G	Lt	Z	H	F	J	K	DN	Weight	PN	Pack
11141003	3/8"	12	47	71	45	65	45	10	95	16	160
11141005	1/2"	15	45	75	45	65	45	15	105	16	160
11141007	3/4"	16	57	89	54	73	55	20	204	16	90
11141010	1"	19	64	102	66	78	66	25	284	16	50
11141013	1.1/4"	22	76	120	74	96	80	32	479	16	40
11141015	1.1/2"	22	98	142	86	110	96	40	681	16	28
11141020	2"	26	117	169	106	129	118	50	1439	16	13
11141025	2.1/2"	44	137	215	128	132	139	65	2000	10	4
11141030	3"	51	148	250	146	153	165	80	3250	10	2
11141040	4"	61	173	295	173	185	207	100	6300	10	2

**VALVES**

**Threaded Support**

**112400-112700\***  
**Bistop Valve - Cemented**

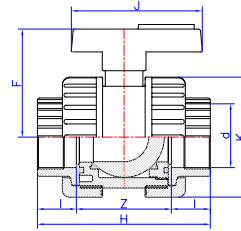
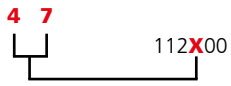

Cod	G	DN	I	Z	H	F	J	K	Weight	PN	Pack
112X0016	16	10	14	43	71	45	65	45	93	16	80
112X0020	20	15	16	43	75	45	65	45	103	16	80
112X0025	25	20	19	51	89	54	73	55	201	16	52
112X0032	32	25	22	58	102	66	78	66	281	16	30
112X0040	40	32	26	68	120	74	96	80	475	16	22
112X0050	50	40	31	80	142	86	110	96	672	16	13
112X0063	63	50	38	93	169	106	129	118	1434	16	6
112X0075	75	65	44	137	215	128	132	139	2000	10	4
112X0090	90	80	51	148	250	146	153	165	3250	10	2
112X0110	110	100	61	173	295	173	185	207	6300	10	2

\* with FPM O-Ring

**INDIVIDUALLY TESTED**

**112410-112710\***  
**Bistop Valve - Threaded**

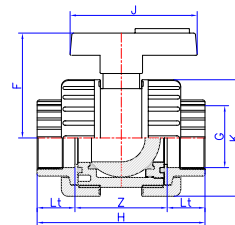

Cod	G	DN	I	Z	H	F	J	K	Weight	PN	Pack
112X1003	3/8"	10	12	47	71	45	65	45	95	16	80
112X1005	1/2"	15	15	45	75	45	65	45	105	16	80
112X1007	3/4"	20	16	57	89	54	73	55	204	16	52
112X1010	1"	25	19	64	102	66	78	66	284	16	30
112X1013	1.1/4"	32	22	76	120	74	96	80	479	16	22
112X1015	1.1/2"	40	22	98	142	86	110	96	681	16	13
112X1020	2"	50	26	117	169	106	129	118	1439	16	6
112X1025	2.1/2"	65	44	137	215	128	132	139	2000	10	4
112X1030	3"	80	51	148	250	146	153	165	3250	10	2
112X1040	4"	100	61	173	295	173	185	207	6300	10	2

\* with FPM O-Ring

**INDIVIDUALLY TESTED**



**VALVES**

**Threaded Support**

**113400**  
**One Nut Valve**  
**Cemented**

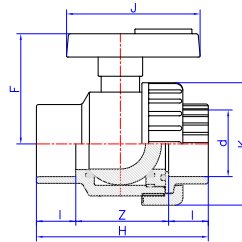

Cod	d	DN	I	Z	J	H	F	K	Weight	PN	Pack
11340016	16	10	14	41	69	45	65	45	85	16	200
11340020	20	15	16	41	73	45	65	45	90	16	200
11340025	25	20	19	49	87	54	73	55	159	16	110
11340032	32	25	22	55	99	66	78	66	222	16	60
11340040	40	32	26	64	116	74	96	80	376	16	45
11340050	50	40	31	76	138	86	110	96	536	16	25
11340063	63	50	38	90	166	106	129	118	1109	16	15
11340075	75	65	44	137	215	128	132	139	1800	10	6
11340090	90	80	51	148	250	146	153	165	2850	10	4
11340110	110	100	61	173	295	173	185	207	5300	10	2

**113410**  
**One Nut Valve**  
**Threaded**

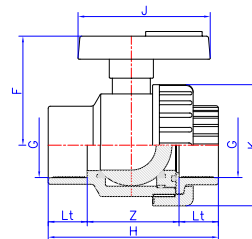

Cod	G	DN	I	Z	J	H	F	K	Weight	PN	Pack
11341003	3/8"	10	14	41	69	45	65	45	85	16	200
11341005	1/2"	15	16	41	73	45	65	45	90	16	200
11341007	3/4"	20	19	49	87	54	73	55	159	16	110
11341010	1"	25	22	55	99	66	78	66	222	16	60
11341013	1.1/4"	32	26	64	116	74	96	80	376	16	45
11341015	1.1/2"	40	31	76	138	86	110	96	536	16	25
11341020	2"	50	38	90	166	106	129	118	1109	16	15
11341025	2.1/2"	65	44	137	215	128	132	139	1800	10	6
11341030	3"	80	51	148	250	146	153	165	2850	10	4
11341040	4"	100	61	173	295	173	185	207	5300	10	2

**VALVES**

**Threaded Support**

**113710**  
**One Nut Valve**  
Threaded

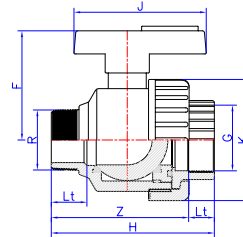

Cod	RxG	Lt	Z	H	F	J	K	DN	Weight	PN	Pack
11371003	3/8"	12	55	67	45	65	45	10	76	16	200
11371005	1/2"	15	57	72	45	65	45	15	82	16	200
11371007	3/4"	16	68	84	54	73	55	20	150	16	110
11371010	1"	19	79	98	66	78	66	25	214	16	60
11371013	1.1/4"	22	90	112	74	96	80	32	359	16	45
11371015	1.1/2"	22	108	130	86	110	96	40	504	16	25
11371020	2"	26	133	159	106	129	118	50	1086	16	15

**113790**  
**One Nut Valve**  
Female-Threaded-Compression

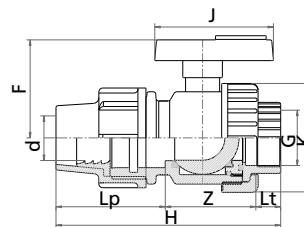

Cod	dxG	Lt	Z	Lp	H	F	J	K	DN	Weight	PN	Pack
113790020	1/2" x 20	15	40	57	112	45	65	45	15	128	16	110
113790025	3/4" x 25	16	50	58	124	54	73	55	20	212	16	70
113790032	1" x 32	19	53	65	137	66	78	66	25	308	16	40
113790040	1.1/4" x 40	22	67	85	174	74	96	80	32	531	16	25
113790050	1.1/2" x 50	22	82	90	194	86	110	96	40	753	16	20
113790063	2" x 63	26	95	109	230	106	129	118	50	1463	16	10

**VALVES**

**Threaded Support**

**111480  
Two Nut Valve  
PE End Connector**

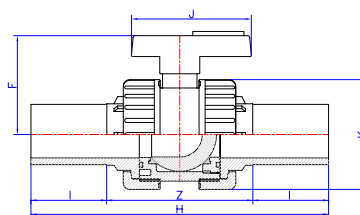

Cod	d	DN	I	Z	J	H	F	K	Weight	PN	Pack
111480020	20	15	41	63	65	145	45	45	110	16	80
111480025	25	20	50	93	73	193	54	55	205	16	60
111480032	32	25	44	102	78	190	66	66	267	16	40
111480040	40	32	48	107	96	203	74	80	471	16	30
111480050	50	40	54	130	110	238	86	96	686	16	15
111480063	63	50	64	142	129	270	106	118	1418	16	10
*111480075	75	65	80	171	132	331	128	139	2000	10	4
*111480090	90	80	88	200	153	376	146	165	3250	10	3
*111480110	110	100	91	233	185	415	173	207	6300	10	1

\* DELIVERY PROGRAM

**113780  
One Nut Valve  
Compressor  
PE End Connector**

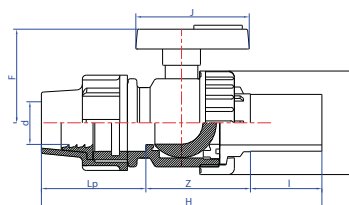

Cod	d	DN	I	Z	Lp	H	F	J	K	Weight	PN	Pack
11378020	20	15	41	50	57	148	45	65	45	119	16	80
11378025	25	20	50	71	58	179	54	73	55	208	16	70
11378032	32	25	44	75	65	184	66	78	66	288	16	40
11378040	40	32	48	86,5	85	219,5	74	96	80	500	16	30
11378050	50	40	54	107	90	251	86	110	96	720	16	15
11378063	63	50	64	119,5	109	292,5	106	129	118	1440	16	10

**CHECK VALVES**

**110800-110600**  
**110900-110000**  
**Check Valve**  
**Cemented**

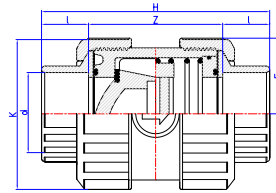

Cod	d	l	Z	H	F	K	Weight	PN	Pack
110X0016	16	14	43	71	23	45	90	16	80
110X0020	20	16	43	75	23	45	90	16	80
110X0025	25	19	51	89	29	55	145	16	52
110X0032	32	22	58	102	37	66	245	16	30
110X0040	40	26	68	120	44	80	410	16	22
110X0050	50	31	80	142	54	96	690	16	13
110X0063	63	38	93	169	65	118	1170	16	6
110X0075	75	44	137	215	108	139	1810	10	4
110X0090	90	51	148	250	125	165	3015	10	3
110X0110	110	61	173	295	148	207	5540	10	2

- with FPM O-ring 110000
- with EPDM O-ring 110600
- with PTFE coated spring + EPDM O-rings 110800
- with PTFE coated spring + FPM O-rings 110900

**110810-110610**  
**110910-110010**  
**Check Valve**  
**Threaded**

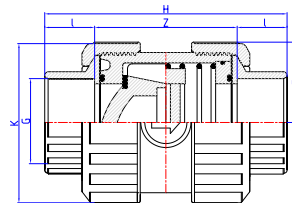

Cod	G	l	Z	H	F	K	DN	Weight	PN	Pack
110X1003	3/8"	14	43	71	23	45	10	90	16	80
110X1005	1/2"	16	43	75	23	45	15	90	16	80
110X1007	3/4"	19	51	89	29	55	20	145	16	52
110X1010	1"	22	58	102	37	66	25	245	16	30
110X1018	1.1/4"	26	68	120	44	80	32	410	16	22
110X1015	1.1/2"	31	80	142	54	96	40	690	16	13
110X1020	2"	38	93	169	65	118	50	1170	16	6
110X1025	2.1/2"	44	137	215	108	139	65	1810	10	4
110X1030	3"	51	148	250	125	165	80	3015	10	3
110X1040	4"	61	173	295	148	207	100	5540	10	2

- with FPM O-ring 110010
- with EPDM O-ring 110610
- with PTFE coated spring + EPDM O-rings 110810
- with PTFE coated spring + FPM O-rings 110910

**CHECK VALVES**

**050408**  
**Kmocker Tee**  
 Cemented

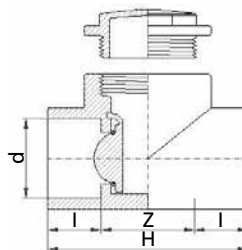

Cod	d	l	z	H	Weight	PN	Pack
050408032	32	22	39	86	138	10	80
050408040	40	26	47	101	200	10	80
050408050	50	31	59	123	292	10	20
050408063	63	38	73	150	500	10	20

**FOOT VALVES**

**116400-116000**  
**Foot Valve**  
Cemented

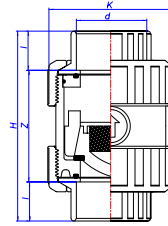

Cod	d	DN	l	Z	H	F	K	Weight	PN	Pack
116X00016	16	10	14	43	71	23	45	93	16	80
116X00020	20	15	16	43	75	23	45	93	16	80
116X00025	25	20	19	51	89	29	55	155	16	52
116X00032	32	25	22	58	102	37	66	265	16	30
116X00040	40	32	26	68	120	44	80	465	16	22
116X00050	50	40	31	80	142	54	96	785	16	13
116X00063	63	50	38	93	169	65	118	1355	16	6
116X00075	75	65	44	137	215	108	139	2100	10	4
116X00090	90	80	51	148	250	125	165	3500	10	3
116X00110	110	100	61	173	295	148	207	6415	10	2

with EPDM O-ring 116400  
with FPM O-ring 116000

**116410-116010**  
**Foot Valve**  
Threaded

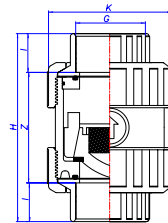

Cod	G	DN	Lt	Z	H	F	K	Weight	PN	Pack
116X10003	3/8"	10	12	47	71	23	45	95	16	80
116X10005	1/2"	15	15	45	75	23	45	105	16	80
116X10007	3/4"	20	16	57	89	29	55	204	16	52
116X10010	1"	25	19	64	102	37	66	284	16	30
116X10013	1.1/4"	32	22	76	120	44	80	479	16	22
116X10015	1.1/2"	40	22	98	142	54	96	681	16	13
116X10020	2"	50	26	117	169	65	118	1439	16	6
116X10025	2.1/2"	65	44	137	215	108	139	2200	10	4
116X10030	3"	80	51	148	250	125	165	3600	10	3
116X10040	4"	100	61	173	295	148	207	6600	10	2

with EPDM O-ring 116410  
with FPM O-ring 116010

**AIR RELEASE VALVES**

**116300-116900**  
**Air Release Valve**  
Cemented

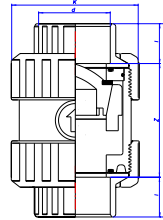

Cod	d	DN	l	Z	H	F	K	Weight	PN	Pack
116X00016	16	10	14	43	71	23	45	88	16	80
116X00020	20	15	16	43	75	23	45	88	16	80
116X00025	25	20	19	51	89	29	55	145	16	52
116X00032	32	25	22	58	102	37	66	240	16	30
116X00040	40	32	26	68	120	44	80	405	16	22
116X00050	50	40	31	80	142	54	96	680	16	13
116X00063	63	50	38	93	169	65	118	1145	16	6
116X00075	75	65	44	137	215	108	139	2100	10	4
116X00090	90	80	51	148	250	125	165	3500	10	3
116X00110	110	100	61	173	295	148	207	6415	10	2

with EPDM O-ring 116300  
with FPM O-ring 116900

**116310-116910**  
**Air Release Valve**  
Threaded

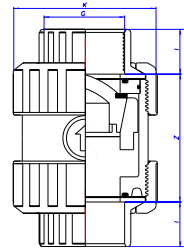

Cod	G	DN	Lt	Z	H	F	K	Weight	PN	Pack
116X10003	3/8"	10	12	47	71	23	45	88	16	80
116X10005	1/2"	15	15	45	75	23	45	88	16	80
116X10007	3/4"	20	16	57	89	29	55	145	16	52
116X10010	1"	25	19	64	102	37	66	240	16	30
116X10013	1.1/4"	32	22	76	120	44	80	405	16	22
116X10015	1.1/2"	40	22	98	142	54	96	680	16	13
116X10020	2"	50	26	117	169	65	118	1145	16	6
116X10025	2.1/2"	65	44	137	215	108	139	2200	10	4
116X10030	3"	80	51	148	250	125	165	3600	10	3
116X10040	4"	100	61	173	295	148	207	6600	10	2

with EPDM O-ring 116310  
with FPM O-ring 116910

**VALVES ACCESSORIES**

**111100**  
**Valve Collar**  
Cemented

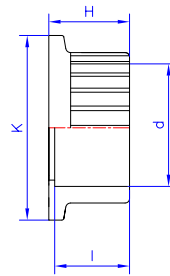

Cod	d	K	H	l	Weight	PN
11110016	16	33	20	14	9	16
11110020	20	33	20	16	9	16
11110025	25	40	22	19	25	16
11110032	32	50	26	22	20	16
11110040	40	61	30	26	41	16
11110050	50	73	34	31	68	16
11110063	63	94	42	38	114	16
11110075	75	119	47	44	174	10
11110090	90	143	56	51	300	10
11110110	110	165	67	61	492	10

**111110**  
**Valve Collar**  
Threaded

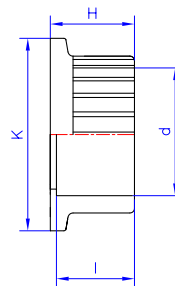

Cod	G	K	H	Lt	Weight	PN
11111003	3/8"	33	20	12	9	16
11111005	1/2"	33	20	16	9	16
11111007	3/4"	40	22	17	25	16
11111010	1"	50	26	20	20	16
11111018	1.1/4"	61	30	23	41	16
11111015	1.1/2"	73	34	23	68	16
11111020	2"	94	42	27	114	16
11111025	2.1/2"	119	47	32	174	10
11111030	3"	143	56	35	300	10
11111040	4"	165	67	42	492	10



**VALVES ACCESSORIES**

**11112  
Blue Handles**

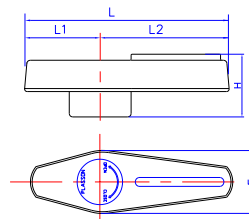

Cod	d	E	H	L	L1	L2	Weight
11112005	16-3/8"	22	22,15	61,7	24,2	37,5	11,2
11112005	20-1/2"	22	22,15	61,7	24,2	37,5	11,2
11112007	25-3/4"	24	25,2	72	29,5	42,5	16
11112010	32-1"	26,5	30	77,5	30	47,5	20,2
11112013	40-1.1/4"	31	32,1	94	37,4	56,6	30
11112015	50-1.1/2"	35	34,9	107,8	42	65,8	38,6
11112020	63-2"	41,5	38	130	52,6	77,3	60,4
11112025	75-2.1/2"	45,3	38	132,8	54,9	77,9	77,2
11112030	90-3"	51,2	42,9	152,7	63	89,7	117,8
11112040	110-4"	56,5	47,3	185,7	75,9	109,1	168,8

**11113  
Red Handles**

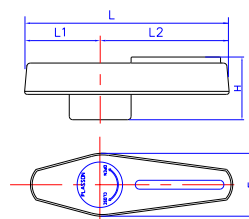

Cod	d	E	H	L	L1	L2	Weight
11112005	16-3/8"	22	22,15	61,7	24,2	37,5	11,2
11112005	20-1/2"	22	22,15	61,7	24,2	37,5	11,2
11112007	25-3/4"	24	25,2	72	29,5	42,5	16
11112010	32-1"	26,5	30	77,5	30	47,5	20,2
11112013	40-1.1/4"	31	32,1	94	37,4	56,6	30
11112015	50-1.1/2"	35	34,9	107,8	42	65,8	38,6
11112020	63-2"	41,5	38	130	52,6	77,3	60,4
11112025	75-2.1/2"	45,3	38	132,8	54,9	77,9	77,2
11112030	90-3"	51,2	42,9	152,7	63	89,7	117,8
11112040	110-4"	56,5	47,3	185,7	75,9	109,1	168,8

**VALVES ACCESSORIES**

**111140  
Valve Nut**

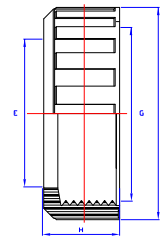

Cod	G	E	E1	H	Weight	PN
11114016	16-3/8"	29	45	18	16	16
11114020	20-1/2"	29	45	18	16	16
11114025	25-3/4"	34	55	21	27	16
11114032	32-1"	41	66	26	46	16
11114040	40-1.1/4"	52	80	29	75	16
11114050	50-1.1/2"	65	96	36	133	16
11114063	63-2"	79	118	40	198	16
11114075	75-2.1/2"	96	139	52	282	10
11114090	90-3"	117	165	59	436	10
11114110	110-4"	142	207	68	830	10

**1115.207  
PE End Connector**

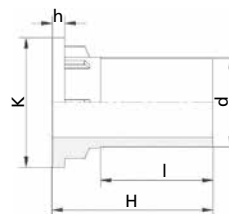

Cod	d	K	h	H	l	W	Weight
1115.207.020	20	33	5	53	41	11	11
1115.207.025	25	40	6	77	50	24	24
1115.207.032	32	49	6	68	44	33	33
1115.207.040	40	60	7	71	48	48	48
1115.207.050	50	73	9	82	54	85	85
1115.207.063	63	91	10	90	64	130	130
*1115.207.075	75	110	7	105	80	222	222
*1115.207.090	90	134	8	119	88	348	348
*1115.207.110	110	163	10	127	91	590	590

\* DELIVERY PROGRAM

**VALVES ACCESSORIES**



**Set of O-Rings  
115 / 125 / 128 / 135 / 134**

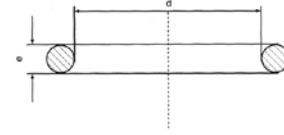

**O-Ring For Stem**

valve code 111500/1 Ø 16 -63  
 valve code 112400/1 Ø 16 - 110  
 valve code 113500/1 Ø 16 -63  
 valve code 113610 Ø 16 -63  
 valve code 113790 Ø 20 -63  
 valve code 111480 Ø 20 -63

**set 115**  
**set 125**  
**set 135**  
**set 135**  
**set 134**  
**set 125**

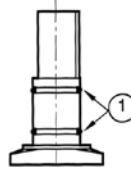

valve code 111400/1 Ø 16-110  
 valve code 112700/1 Ø 16-110\*  
 valve code 113400/1 Ø 16-110  
 valve code 113710 Ø 16 -63  
 valve code 113780 Ø 16 -63  
 valve code 111480 Ø 20 -63

**set 125**  
**set 128**  
**set 134**  
**set 134**  
**set 134**  
**set 125**

	16-3/8"	20-1/2"	25-3/4"	32-1"	40-11/4"	50-11/2"	63-2"	75-21/2"	90-3"	110-4"
Type 1	7219 7,2x1,9	7219 7,2x1,9	952 9,5x2	114 11,11x1,78	3043 10,78x2,72	356 13,95x2,62	467 17,04x3,53	475 18,64x3,53	487 21,82x3,53	134 25,8x3,53

**O-Ring For Spacing**

**Normal Support**  
 Valve code 111500/1  
 Valve code 113500/1  
 Valve code 113610

**set 115**  
**set 135**  
**set 135**

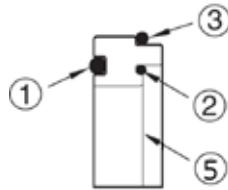

**Threaded Support**  
 Valve code 111400/1  
 Valve code 112400/1  
 Valve code \*112700/1  
 Valve code 113710  
 Valve code 113790  
 Valve code 113780  
 Valve code 111480

**set 125**  
**set 125**  
**set 128**  
**set 134**  
**set 134**  
**set 134**  
**set 125**

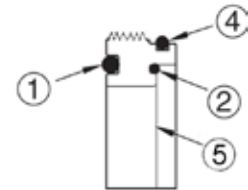

	16-3/8"	20-1/2"	25-3/4"	32-1"	40-11/4"	50-11/2"	63-2"	75-21/2"	90-3"	110-4"
Type 1	3075 18,72x2,62	3075 18,72x2,62	3100 25,07x2,62	4118 29,75x3,53	4150 37,7x3,53	6187 47x5,43	6237 59,7x5,34	6325 84,92x5,34	6387 97,79x5,34	119 117,48x5,34
Type 2	9999 17,5x1,5	9999 17,5x1,5	2093 23,52x1,78	2118 29,87x1,78	3143 36,17x2,62	3181 45,7,2,62	3231 58,42x2,62	4287 72,62x3,53	4350 88,5x3,53	4425 107,5x3,53
Type 3	130 22,23x2,62	130 22,23x2,62	3118 29,83x2,62	4150 37,7x3,53	152 47,62x3,53	161 57,15x3,53	174 71,63x3,53	/		
Type 4	130 22,23x2,62	130 22,23x2,62	3118 29,83x2,62	3143 36,17x2,62	3181 45,7x2,62	3231 58,42x2,62	174 71,63x3,53			
Type 5	PTFE020 15x21x3	PTFE020 15x21x3	PTFE025 20x27x3,5	PTFE032 25x33x4	PTFE040 32x42x5	PTFE050 40x51x5,5	PTFE063 50x63x6,5	PTFE075 65x82x6	PTFE090 80,5x95,6x7,5	PTFE110 100,5x116x9

**O-Ring For Body**

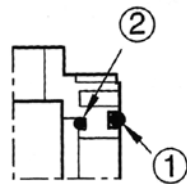

**Only for compression side valves**

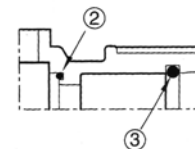

	16-3/8"	20-1/2"	25-3/4"	32-1"	40-11/4"	50-11/2"	63-2"	75-21/2"	90-3"	110-4"
Type 1	3075 18,72x2,62	3075 18,72x2,62	3100 25,07x2,62	4118 29,75x3,53	4150 37,7x3,53	6187 47x5,43	6237 59,7x5,34	6325 84,92x5,34	6387 97,79x5,34	119 117,48x5,34
Type 2	9999 17,5x1,5	9999 17,5x1,5	2093 23,52x1,78	2118 29,87x1,78	3143 36,17x2,62	3181 45,7,2,62	3231 58,42x2,62	4287 72,62x3,53	4350 88,5x3,53	4425 107,5x3,53
Type 3	/		070020020	070020025	070020032	070020040	070020050	070020063	/	
Type 5	PTFE020 15x21x3	PTFE020 15x21x3	PTFE025 20x27x3,5	PTFE032 25x33x4	PTFE040 32x42x5	PTFE050 40x51x5,5	PTFE063 50x63x6,5	PTFE075 65x82x6	PTFE090 80,5x95,6x7,5	PTFE110 100,5x116x9

\* Set of FPM O-Rings

**VALVES ACCESSORIES**  
CHECK - FOOT - AIR - RELEASE VALVES



**Set of O-Rings**  
**\* 100 / 106**

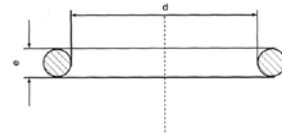

**Gasket For Piston**

valve code 110800/1 Ø 16 -110  
 valve code 110600/1 Ø 16 -110  
 valve code 110900/1 Ø 16 -110\*  
 valve code 110000/1 Ø 16 -110\*  
 valve code 116400/1 Ø 16 -110  
 valve code 116000/1 Ø 16 -110\*

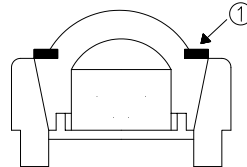

valve code 116300/1 Ø 16-110  
 valve code 116900/1 Ø 16-110\*

	16-3/8"	20-1/2"	25-3/4"	32-1"	40-11/4"	50-11/2"	63-2"	75-21/2"	90-3"	110-4"
Type 1	*GP020V 12,5x20x2	*GP020V 12,5x20x2	*GP025V 17x24x2	*GP032V 22x32x2	*GP040V 38x28x3	*GP050V 51x35x4	*GP063V 58x42x4	*GP075V 57x77x4	*GP090V 72x93x4	*GP090V 110x90x4

**O-Ring For Spacing**

Normal Support

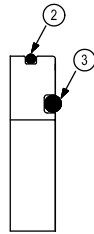

	16-3/8"	20-1/2"	25-3/4"	32-1"	40-11/4"	50-11/2"	63-2"	75-21/2"	90-3"	110-4"
Type 2	130 22,23x2,62	130 22,23x2,62	3118 29,83x2,62	3143 36,17x2,62	3181 45,7x2,62	3231 58,42x2,62	174 71,63x3,53	4362 91,67x3,53	6450 113,7x5,34	4562 142,47x3,53
Type 3	3075 18,72x2,62	3075 18,72x2,62	3100 25,07x2,62	4118 29,75x3,53	4150 37,7x3,53	6187 47x5,43	6237 59,7x5,34	6325 84,92x5,34	6387 97,79x5,34	119 117,48x5,34

**O-Ring For Body**

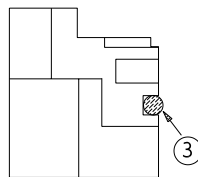

	16-3/8"	20-1/2"	25-3/4"	32-1"	40-11/4"	50-11/2"	63-2"	75-21/2"	90-3"	110-4"
Type 3	3075 18,72x2,62	3075 18,72x2,62	3100 25,07x2,62	4118 29,75x3,53	4150 37,7x3,53	6187 47x5,43	6237 59,7x5,34	6325 84,92x5,34	6387 97,79x5,34	119 117,48x5,34

**Spring**

Stainless steel 316 core Spring

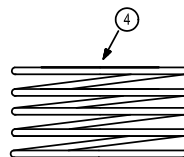

Teflon coated onstainless steel 316 core Spring

	16-3/8"	20-1/2"	25-3/4"	32-1"	40-11/4"	50-11/2"	63-2"	75-21/2"	90-3"	110-4"
Type 4	ML020	ML020	ML025	ML032	ML040	ML050	ML063	ML075	ML090	ML110

\* Set of FPM O-Rings

## TECHNICAL SPECIFICATIONS - FITTINGS

### Product Description

#### DESCRIPTION -

Precision moulded pressure pipe fittings and flanges made from PVC-U250 suitable for PVC pipe systems up to 16 bar. Our comprehensive range of items and sizes can be joined either by cold solvent cementing or through threading. Sizes and dimensions conform to international standard. All fittings are suitable for potable water, beverages, and food contact, as well as corrosive\* fluid transports.

\* For specific chemicals, please consult your sales rep.

#### STANDARDS -

Products conform to the requirements of ISO 264, 727, 2536, 3460, KIWA Criteria Std. Nr. 54 and DIN 8063, 19532, UNI EN 1452-3, AFNOR 54-029 and 54-028.

#### MATERIALS -

PVC-U250 unplasticized poly (vinyl chloride) meeting the above mentioned Standards.

Injection-moulded components: PVC-U250.

Metal reinforced rings: on the female threads INOX AISI 430.

Gaskets and O-Rings: EPDM.

#### MARKINGS -

The fittings and valves incorporate the following information moulded in relief:

- PLASSON Trade Mark (registered in most countries)
- Diameter of connection
- Nominal pressure
- Type of Material

#### COLOUR -

All fittings and valves are grey, in accordance with PVC-U pressure pipeline standards.

#### ITEMS -

Sockets, 45o and 90o Elbows, 90o Tees, Bushes, Unions, Reducers, Adaptors, Hose Nozzles, Caps, Plugs, Nipples, Flanges, Flange Adaptors, Ball Valves, Foot Valves, Check Valves, and Air Release Valves.

#### SANITARY LAWS -

The PLASSON fittings and valves conform to the sanitary laws and regulations in force in the various European Countries and in the U.S. relating to transportation of potable water, wine, beverages and food.

#### APPLICATION FIELDS -

Potable water systems, irrigation systems (including fertilization), installation for wine, beer, beverages and other fluids, industrial plants, conveyance of acids, bases, salts, fresh or swimming water, ship installations. (for special installations, please contact your Plasson supplier).

#### JOINTING TYPES -

The fittings and the valves are available with three types of connections:

Plain ends for solvent cement jointing to pressure pipes of metric dimensions.

Fourth digit in the catalogue no. is "O" (XXXO).

Threaded ends to be screwed onto BSP threaded pipes/ fittings.

Fourth digit in the catalogue no. is "1" (XXX1).

A combination of ends ("adaptor fittings") suitable for joining a PVC pipeline of the metric dimensions to a BSP threaded pipe, fitting, valve or accessory (PVC or other materials).

Fourth digit in the catalogue no. is "2" (XXX2).

#### SIZES -

For standard pipes of the ISO metrical range: 12, 16, 20, 25, 32, 40, 50, 63, 75, 90, 110, 125, 140, 160, 200, 225mm.

And for pipes of the BSP threaded range: 1/4", 3/8", 1/2", 3/4", 1", 1 1/4", 1 1/2", 2", 2 1/4", 3", 4", 5".

#### THREADS -

PLASSON fittings are female threaded (cylindrical) and male threaded (conical) in accordance with ISO, BS 21, and UNI 339 standards.

#### FLANGES -

PLASSON backing flanges are to be used in connection with the flange adaptors (catalogue no. 5500, 5510, and 5520).

The number, sizes and distance between the centre of the holes conform to UNI 2223, EN 1452-3, ISO 2536 and DIN 8063 for pressure classes of 10-16 Bar.

#### ACCESSORIES -

The fitting range is completed by some accessories such as solvent cement, primer, PTFE tape, etc.

#### WORKING TEMPERATURES -

CELSIUS	0°-25°	25°-30°	30°-35°	35°-40°	40°-45°
PFA* (PN) Bar	16	14,4	12,8	11,2	10
PFA* (PN) Bar	10	9	8	7	6,25

\* in accordance with EN 805

#### PRESSURES -

The fittings and valves, in accordance with EN 805 standard, have three working pressures: PTA (PA), PMA and PEA.

To every PFA values are connected the following PMA and PEA:

	PFA -PA	PMA	PEA
PRESSURES	16	20	24
IN BAR	10	12,5	15
	6	7,5	9

**TECHNICAL SPECIFICATIONS - FITTINGS**

Product Description

**PVC PROPERTIES -**

The following are the required properties for injection moulded PVC-U250 fittings and valves in accordance with ISO-EN-UNI Standards:

CHARACTERISTICS	UNITS	VALUES	STANDARDS
Density at 23°C	Kg/dm <sup>3</sup>	1.39	ISO 1183
Vicat 5 Kg.	°C	77	ISO 306
Tensile impact strength	KJ/m <sup>2</sup>	≥513	ISO 527
Tensile strength at break	MPa	≥49	ISO 527
Elongation at break	%	≥120	ISO 527
Yield stress	MPa	46	ISO 527
Flexural modulus	MPa	≥3000	ISO 527
Heat conductivity at 23 °C	W/mK	0,13-0,19	ASTM C 177
Specific heat at 23 °C	J/Kg K	900-1000	-
Fire resistance (0,85 mm.)		V 0	UL 94

**Permissible working pressures in accordance with DIN8062**

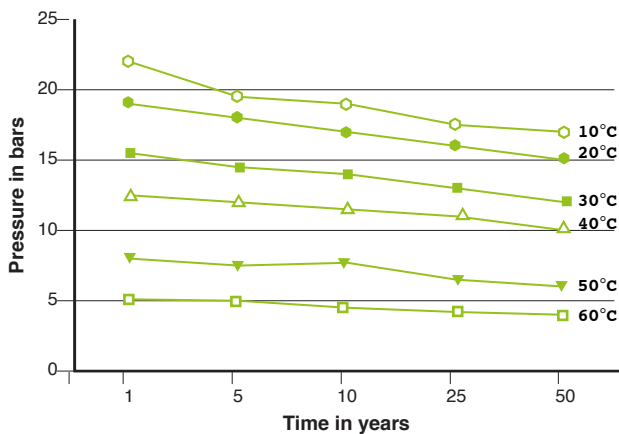

**ABBREVIATIONS USED IN THIS CATALOGUE -**

d, d <sub>1</sub>	Nominal inside diameter
G, G <sub>1</sub>	Nominal size of thread in inches
DN	Nominal bore
D, D <sub>1</sub>	Outside diameter
E, E <sub>1</sub>	Maximum overall external diameter
l, l <sub>1</sub>	Internal length of cementing
L, L <sub>1</sub> , L <sub>2</sub>	External length for cementing
Lt, Lt <sub>1</sub>	Length of thread
Z	Length from pipe stop to centre/other pipe stop
C	External size of octagon
B	Length of rim
Dp	Pitch circle diameter of bolt holes in flanges
S	Diameter of bolt holes in flanges
N	Number of bolt holes in flange
e	Cross section diameter of O-Ring
H	Total length
W	Weight in grams

**SYMBOLS & DEFINITIONS FITTINGS -**

**PN - Nominal Pressure in Bar** - Allowable operating pressure conveying water at 20OC during 50 years.

**PFA - Allowable Operating Pressure** - Maximum hydrostatic pressure that a component is capable of withstanding continuously in service (EN 805:1999); for water at temperatures up to 25OC: PFA=PN.

**PMA - Allowable Maximum Operating Pressure** - Maximum pressure occurring from time to time, including surge, that a component is capable of withstanding in service (EN 805:1999).

**PEA - Allowable Site Test Pressure** - Maximum hydrostatic pressure that a newly installed component is capable of withstanding for a relatively short duration, in order to ensure the integrity and tightness of the pipeline (EN 805:1999).

**MRS: Minimum Required Strength**

**PVC-U: Unplasticized Poly (vinyl chloride)**

**PVC-U250: Unplasticized Poly (vinyl chloride) material for injectionmoulded components, such as PLASSON fittings and valves, with a proved MRS-value of at least 25Mpa.**

**EPDM: Ethylene Propylene Rubber**

**FPM: Fluoride Rubber (VITON)**

**PTFE: Polytetrafluoroethylene**

## TECHNICAL SPECIFICATIONS - VALVES

### Product Description

#### DESCRIPTION -

Precision moulded valves made from uPVC suitable for line pipe systems up to 16 bar. Our comprehensive range of items and sizes can be connected either by cold solvent cementing or through threading. Sizes and dimensions conform to international standards. All valves are suitable for potable water, beverages, food as well as corrosive fluid transport.

#### MATERIALS -

PVC-U250 (unplasticized polyvinyl chloride) meeting the standards of DIN-BS-UNI-AFNOR, KIWA, etc

#### O-Rings -

- 1) EPDM (ethylene-propylene copolymer). Hardness: 70 shore, unless otherwise specified
- 2) FPM (Fluorised-Rubber) Hardness: 70 shore, unless otherwise specified

#### Springs -

- 1) PTFE coated stainless steel 316 core
- 2) Coated Springs: Teflon coated on stainless steel 316 core

#### Gaskets (on ball) -

- 1) PTFE (Polytetra Fluorised-Ethylene)
- 2) PE

#### MARKINGS -

The valves incorporate the following information moulded in relief:

- Plasson Trade Mark (registered in most countries)
- Diameter of connection
- Nominal pressure
- Type of Material

#### COLOUR -

All valves are grey, in accordance with PVC-U pressure pipeline standards.  
Handles are blue or red.

#### ITEMS -

Ball Valves, Check Valves, Foot Valves, Air Release Valves

#### SANITARY LAWS -

The PLASSON valves conform to the sanitary laws and regulations in force in the various European Countries and in the U.S. relating to transportation of potable water, wine, beverages and food.

#### APPLICATION FIELDS -

Potable water systems, irrigation systems (including fertilization), installation for wine, beer, beverages and other fluids, industrial plants, conveyence of acids, bases, salts, fresh or swimming water pool, ship installations. (for special installations, please contact your Plasson supplier).

#### JOINTING TYPES -

The valves are available with three types of connections: Plain ends for solvent cement jointing to pressure pipes of metric dimensions. *Fourth digit in the catalogue no. is "0" (XXX0).* Threaded ends to be screwed onto BSP threaded pipes/ fittings. *Fourth digit in the catalogue no. is "1" (XXX1).*

#### SIZES -

For standard pipes of the ISO metrical range of mm: 16, 20, 25, 32, 40, 50, 63, 75, 90, 110

And for pipes of the BSP threaded range: 3/8", 1/2", 3/4", 1", 1 1/4", 1 1/2", 2", 2 1/2", 3"

#### THREADS -

PLASSON valves are female threaded (cylindrical) and male threaded (conical) according with ISO 7, UNI 339, DIN 2999 and BS 21 standards.

#### MECHANICAL PROPERTIES -

Maximum working pressure in bars:

Δ16-63: PN16

Δ75-110: PN10

Minimun pressure TEE Clapet: 0,2bar

Minimun opening pressure Check Valves: 0,5bar

#### PVC PROPERTIES -

The following are the required properties for an injection moulded PVC fittings withstanding pressures PN16 in accordance with UNI standards:

CHARACTERISTICS	UNITS	VALUES	STANDARDS
Density	Kg/m <sup>3</sup>	1.4	ISO 1183
Vicat (50N)	°C	76	ISO 306-B
Yield stress	MPa	45	ISO 527
Tensile Strength at break (23°)	MPa	40	ISO 527
Elongation at break	%	120	ISO 527
Tensile Modulus	MPa	3000	ISO 527

			Unnotched j/m	Notched j/m
IZOD Impact Strength	ASTM 23°C		NB	270
	D256 0°C		NB	150
	ISO180 0°C		>1500	70

#### Permissable working pressures in accordance with DIN8062

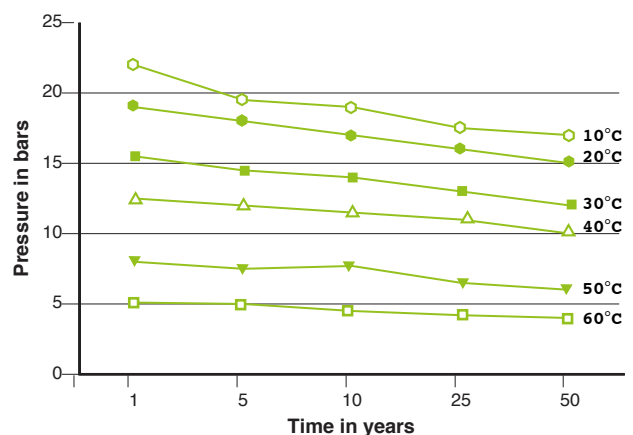

## TECHNICAL SPECIFICATIONS - VALVES

### Product Description

#### ABBREVIATIONS USED IN THIS CATALOGUE -

d	Nominal inside diameter
F	Distance from centre of valve to top of handle or valve
G	Nominal size of thread in inches
J	Length of handle
K	Outside diameter or nut
DN	Nominal bore corresponding approx to the inside diameter of the pipe
D	Outside diameter
I	Internal length for cementing
L	External length for cementing
Lp	Internal length to PE pipe
Lt	Length of thread
Z	Length from pipe stop to centre/other pipe stop
H	Total length
W	Weight in grams

#### SYMBOLS & DEFINITIONS FITTINGS -

**PN - Nominal Pressure in Bar** - Allowable operating pressure conveying water at 20OC during 50 years.

**PFA - Allowable Operating Pressure** - Maximum hydrostatic pressure that a component is capable of withstanding continuously in service (EN 805:1999); for water at temperatures up to 25OC: PFA=PN.

**PMA - Allowable Maximum Operating Pressure** - Maximum pressure occurring from time to time, including surge, that a component is capable of withstanding in service (EN 805:1999).

**PEA - Allowable Site Test Pressure** - Maximum hydrostatic pressure that a newly installed component is capable of withstanding for a relatively short duration, in order to ensure the integrity and tightness of the pipeline (EN 805:1999).

**MRS: Minimum Required Strength**

**PVC-U: Unplasticized Poly (vinyl chloride)**

**PVC-U250: Unplasticized Poly (vinyl chloride) material for injectionmoulded components, such as PLASSON fittings and valves, with a proved MRS-value of at least 25Mpa.**

**EPDM: Ethylene Propylene Rubber**

**FPM: Fluoride Rubber (VITON)**

**PTFE: Polytetrafluoroethylene**



**ASSEMBLY INSTRUCTIONS**

**Normal Support**

**111500  
111510**

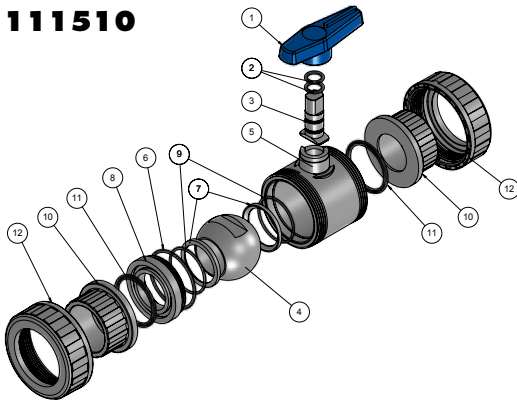

**Instructions for connection to the system -**

- A) Completely unscrew the ring nuts (12) and fit them to the pipe that the valve is to be connected to.
- B) Either glue or screw couplings (10) at the pipe ends.
- C) Position the valve body (5) between the two couplings.
- D) Lock the ring nuts for both sides.

**Instructions for disassembling and reassemble -**

Completely unscrew the ring nuts (12). Remove the valve body (5) radially. Remove the handle (1) by pulling upwards. Release the gasket support (8) by pushing the ball (4) through the valve while the valve is closed. Remove O-Rings (6\*, 9\*, 11\*) from gasket

support (8) and PTFE gasket (7\*) using a suitable tool in order to prevent damage. Remove the ball (4) which was previously positioned during the closing phase. Remove the stem (3) by pushing downwards and extracting it from inside the valve body. Remove the O-Ring (2\*) from the stem (3) using a suitable tool. Remove the O-Ring (9\*) and the PTFE gasket (7\*) using a suitable tool. To assemble the valve, follow the same procedure in the opposite sequence.

**Notes:** The valve shall be supplied with a pre-set radial seal, applicable to average operating conditions; due to particular operating conditions, it might be necessary to turn clockwise or anticlockwise the ring nuts (12) from the side of the gasket support (8).

**113500  
113510**

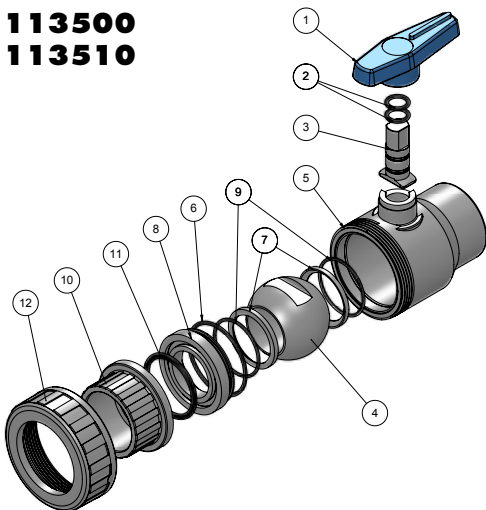

**Instructions for connection to the system -**

- A) Completely unscrew the ring nut (12) and fit it to the pipe that the valve is to be connected to.
- B) Either glue or screw fixed side (5) to the pipe end.
- C) Either glue or screw coupling (10) to the pipe end.
- D) Lock the ring nut.

**Instructions for disassembling and reassemble -**

Completely unscrew the ring nut (12). Remove the valve body (5) radially. Remove the handle (1) by pulling upwards. Release the gasket support (8) by pushing the ball (4) through the valve while the valve is closed. Remove O-Rings (6\*, 9\*, 11\*) from gasket

support (8) and PTFE gasket (7\*) using a suitable tool in order to prevent damage. Remove the ball (4) which was previously positioned during the closing phase. Remove the stem (3) by pushing downwards and extracting it from inside the valve body. Remove the O-Ring (2\*) from the stem (3) using a suitable tool. Remove the O-Ring (9\*) and the PTFE gasket (7\*) using a suitable tool. To assemble the valve, follow the same procedure in the opposite sequence.

**Notes:** The valve shall be supplied with a pre-set radial seal, applicable to average operating conditions; due to particular operating conditions, it might be necessary to turn clockwise or anticlockwise the ring nut (12).

**113610**

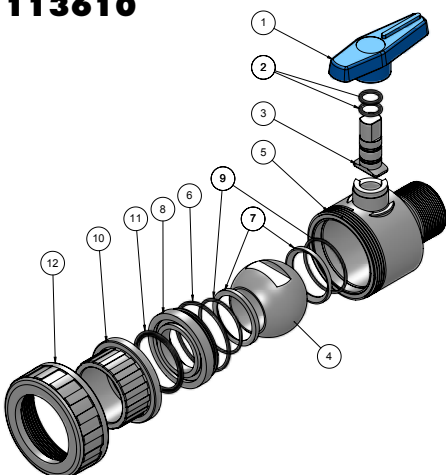

**Instructions for connection to the system -**

- A) Completely unscrew the ring nut (12) and fit it to the pipe that the valve is to be connected to.
- B) Screw fixed side (5) to the pipe end.
- C) Screw coupling (10) to the pipe end.
- D) Lock the ring nut.

**Instructions for disassembling and reassemble -**

Completely unscrew the ring nut (12). Remove the valve body (5) radially. Remove the handle (1) by pulling upwards. Release the gasket support (8) by pushing the ball (4) through the valve while the valve is closed. Remove O-Rings (6\*, 9\*, 11\*) from gasket support (8) and PTFE gasket (7\*) using a

suitable tool in order to prevent damage. Remove the ball (4) which was previously positioned during the closing phase. Remove the stem (3) by pushing downwards and extracting it from inside the valve body. Remove the O-Ring (2\*) from the stem (3) using a suitable tool. Remove the O-Ring (9\*) and the PTFE gasket (7\*) using a suitable tool. To assemble the valve, follow the same procedure in the opposite sequence.

**Notes:** The valve shall be supplied with a pre-set radial seal, applicable to average operating conditions; due to particular operating conditions, it might be necessary to turn clockwise or anticlockwise the ring nut (12).

**ASSEMBLY INSTRUCTIONS**  
Threaded Support

**111400**  
**111410**

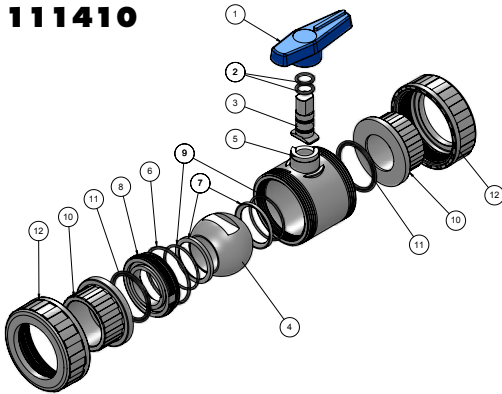

**Instructions for connection to the system -**

- A) Completely unscrew the ring nuts (12) and fit them to the pipe that the valve is to be connected to.
- B) Either glue or screw couplings (10) at the pipe ends.
- C) Position the valve body (5) between the two couplings.
- D) Lock the ring nuts for both sides.

**Instructions for disassembling and reassemble -**

- Completely unscrew the ring nuts (12).
- Completely unscrew the ring nuts (12). Remove the valve body (5) radially.
- Remove the handle (1) by pulling upwards. Insert the key in its seat in the gasket support (8).
- Completely unscrew the gasket support (8) by rotating the handle anticlockwise.
- Remove O-Rings (6\*, 9\*, 11\*) from gasket support (8) and PTFE gasket (7\*) using a suitable tool in order to prevent damage.

- Remove the ball (4) which was previously positioned during the closing phase.
- Remove the stem (3) by pushing downwards and extracting it from inside the valve body.
- Remove the O-Ring (2\*) from the stem (3) using a suitable tool.
- Remove the O-Ring (9\*) and the PTFE gasket (7\*) using a suitable tool.
- To assemble the valve, follow the same procedure in the opposite sequence.

**Notes:** The valve shall be supplied with a pre-set radial seal, applicable to average operating conditions; due to particular operating conditions, it might be necessary to follow the instructions below before performing the final step:

- 1. Disconnected the handle (1) by pulling upwards.
- 2. Insert the key in its seat in the gasket support (8).
- 3. Turn clockwise or anticlockwise to adjust as required.

**112400-112410**  
**112700-112710**

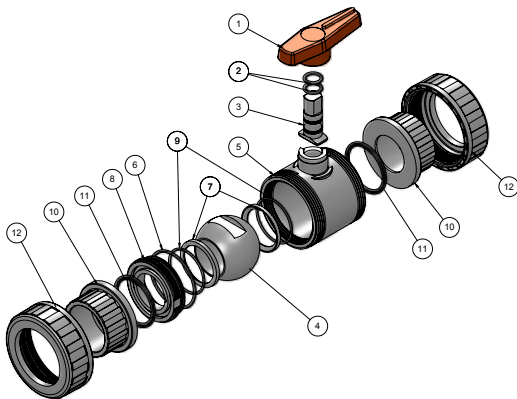

**Instructions for connection to the system -**

- A) Completely unscrew the ring nuts (12) and fit them to the pipe that the valve is to be connected to.
- B) Either glue or screw couplings (10) at the pipe ends.
- C) Position the valve body (5) between the two couplings.
- D) Lock the ring nuts for both sides.

**Instructions for disassembling and reassemble -**

- Completely unscrew the ring nuts (12).
- Remove the valve body (5) radially.
- Remove the handle (1) by pulling upwards. Insert the key in its seat in the gasket support (8).
- Completely unscrew the gasket support (8) by rotating the handle anticlockwise.
- Remove O-Rings (6\*, 9\*, 11\*) from gasket support (8) and PTFE gasket (7\*) using a suitable tool in order to prevent damage.

- Remove the ball (4) which was previously positioned during the closing phase.
- Remove the stem (3) by pushing downwards and extracting it from inside the valve body.
- Remove the O-Ring (2\*) from the stem (3) using a suitable tool.
- Remove the O-Ring (9\*) and the PTFE gasket (7\*) using a suitable tool.
- To assemble the valve, follow the same procedure in the opposite sequence.

**Notes:** The valve shall be supplied with a pre-set radial seal, applicable to average operating conditions; due to particular operating conditions, it might be necessary to follow the instructions below before performing the final step:

- 1. Disconnected the handle (1) by pulling upwards.
- 2. Insert the key in its seat in the gasket support (8).
- 3. Turn clockwise or anticlockwise to adjust as required.

## ASSEMBLY INSTRUCTIONS

### Threaded Support

**113400**  
**113410**

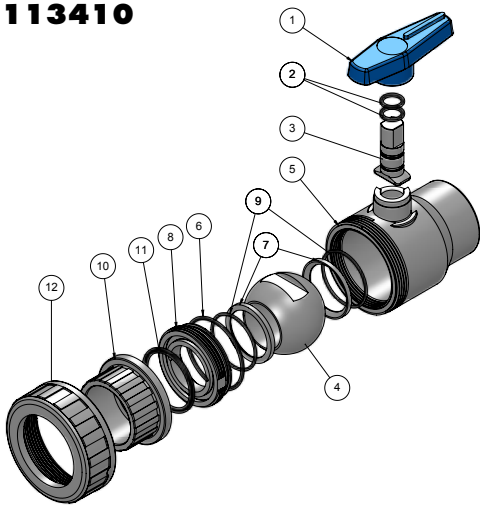

#### Instructions for connection to the system -

- A) Completely unscrew the ring nut (12) and fit it to the pipe that the valve is to be connected to.
- B) Either glue or screw fixed side (5) to the pipe end.
- C) Either glue or screw coupling (10) to the pipe end.
- D) Lock the ring nut.

#### Instructions for disassembling and reassemble -

- Completely unscrew the ring nut (12).
- Remove the valve body (5) radially.
- Remove the handle (1) by pulling upwards.
- Insert the key in its seat in the gasket support (8).
- Completely unscrew the gasket support (8) by rotating the handle anticlockwise.
- Remove O-Rings (6\*, 9\*, 11\*) from gasket support (8) and PTFE gasket (7\*) using a suitable tool in order to prevent damage.

Remove the ball (4) which was previously positioned during the closing phase.

Remove the stem (3) by pushing downwards and extracting it from inside the valve body.

Remove the O-Ring (2\*) from the stem (3) using a suitable tool.

Remove the O-Ring (9\*) and the PTFE gasket (7\*) using a suitable tool.

To assemble the valve, follow the same procedure in the opposite sequence.

**Notes:** The valve shall be supplied with a pre-set radial seal, applicable to average operating conditions; due to particular operating conditions, it might be necessary to follow the instructions below before performing the final step:

1. Disconnected the handle (1) by pulling upwards.
2. Insert the key in its seat in the gasket support (8).
3. Turn clockwise or anticlockwise to adjust as required.

**113710**

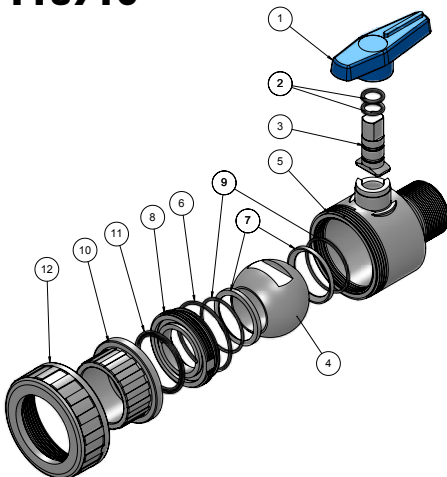

#### Instructions for connection to the system -

- A) Completely unscrew the ring nut (12) and fit it to the pipe that the valve is to be connected to.
- B) Screw fixed side (5) to the pipe end.
- C) Screw coupling (10) to the pipe end.
- D) Lock the ring nut.

#### Instructions for disassembling and reassemble -

- Completely unscrew the ring nut (12).
- Remove the valve body (5) radially.
- Remove the handle (1) by pulling upwards.
- Insert the key in its seat in the gasket support (8).
- Completely unscrew the gasket support (8) by rotating the handle anticlockwise.
- Remove O-Rings (6\*, 9\*, 11\*) from gasket support (8) and PTFE gasket (7\*) using a suitable tool in order to prevent damage.
- Remove the ball (4) which was previously positioned during the closing phase.

Remove the stem (3) by pushing downwards and extracting it from inside the valve body.

Remove the O-Ring (2\*) from the stem (3) using a suitable tool.

Remove the O-Ring (9\*) and the PTFE gasket (7\*) using a suitable tool.

To assemble the valve, follow the same procedure in the opposite sequence.

**Notes:** The valve shall be supplied with a pre-set radial seal, applicable to average operating conditions; due to particular operating conditions, it might be necessary to follow the instructions below before performing the final step:

1. Disconnected the handle (1) by pulling upwards.
2. Insert the key in its seat in the gasket support (8).
3. Turn clockwise or anticlockwise to adjust as required.

**ASSEMBLY INSTRUCTIONS**  
Threaded Support

**113790**

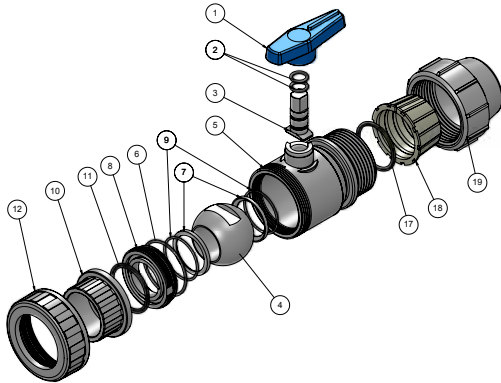

**Instructions for connection to the system -**

- A) Connect PE pipe to the compression nut (19).
- B) Completely unscrew the ring nuts (12) and fit them to the pipe that the valve is to be connected to.
- C) Either glue or screw couplings (10) at the pipe ends.
- D) Position the valve body (5) between the two couplings.
- E) Lock the ring nuts for both sides.

**Instructions for disassembling and reassemble -**

- Completely unscrew the ring nuts (12).
- Remove the valve body (5) radially.
- Remove the handle (1) by pulling upwards.
- Insert the key in its seat in the gasket support (8).
- Completely unscrew the gasket support (8) by rotating the handle anticlockwise.
- Remove O-Rings (6\*, 9\*, 11\*) from gasket support (8) and PTFE gasket (7\*) using a

suitable tool in order to prevent damage. Remove the ball (4) which was previously positioned during the closing phase. Remove the stem (3) by pushing downwards and extracting it from inside the valve body. Remove the O-Ring (2\*) from the stem (3) using a suitable tool. Remove the O-Ring (9\*) and the PTFE gasket (7\*) using a suitable tool. To assemble the valve, follow the same procedure in the opposite sequence.

**Notes:** The valve shall be supplied with a pre-set radial seal, applicable to average operating conditions; due to particular operating conditions, it might be necessary to follow the instructions below before performing the final step:

1. Disconnected the handle (1) by pulling upwards.
2. Insert the key in its seat in the gasket support (8).
3. Turn clockwise or anticlockwise to adjust as required.

**ASSEMBLY INSTRUCTIONS**  
Threaded Support

**111480**

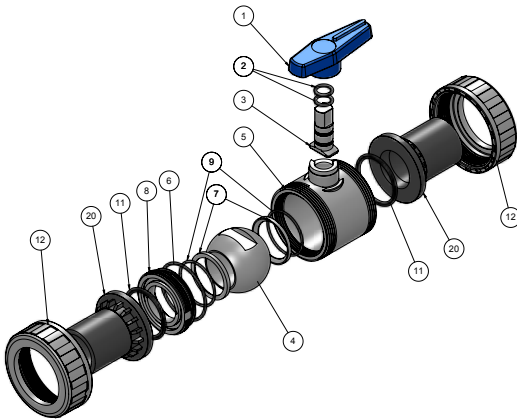

**Instructions for connection to the system -**

- A) Completely unscrew the ring nuts (12) and fit them to the pipe that the valve is to be connected to.
- B) Either connect to the compression fittings or electrofuse or butt weld PE spigots (20) at the pipe ends.
- C) Position the valve body (5) between the two couplings.
- D) Lock the ring nuts for both sides.

**Instructions for disassembling and reassemble -**

- Completely unscrew the ring nuts (12).
- Remove the valve body (5) radially.
- Remove the handle (1) by pulling upwards.
- Insert the key in its seat in the gasket support (8).
- Completely unscrew the gasket support (8) by rotating the handle anticlockwise.
- Remove O-Rings (6\*, 9\*, 11\*) from gasket support (8) and PTFE gasket (7\*) using a suitable tool in order to prevent damage.

Remove the ball (4) which was previously positioned during the closing phase. Remove the stem (3) by pushing downwards and extracting it from inside the valve body. Remove the O-Ring (2\*) from the stem (3) using a suitable tool. Remove the O-Ring (9\*) and the PTFE gasket (7\*) using a suitable tool. To assemble the valve, follow the same procedure in the opposite sequence.

**Notes:** The valve shall be supplied with a pre-set radial seal, applicable to average operating conditions; due to particular operating conditions, it might be necessary to follow the instructions below before performing the final step:

1. Disconnected the handle (1) by pulling upwards.
2. Insert the key in its seat in the gasket support (8).
3. Turn clockwise or anticlockwise to adjust as required.

**113780**

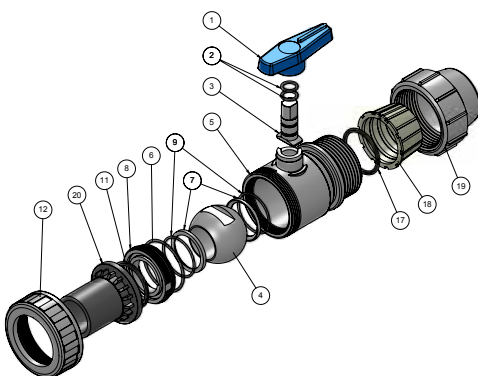

**Instructions for connection to the system -**

- A) Connect PE pipe to the compression nut (19).
- B) Completely unscrew the ring nuts (12) and fit them to the pipe that the valve is to be connected to.
- C) Either connect to the compression fittings or electrofuse or butt weld the PE spigots (20) at the pipe ends.
- D) Position the valve body (5) between the two couplings.
- E) Lock the ring nuts for both sides.

**Instructions for disassembling and reassemble -**

- Completely unscrew the ring nuts (12).
- Remove the valve body (5) radially.
- Remove the handle (1) by pulling upwards.
- Insert the key in its seat in the gasket support (8).
- Completely unscrew the gasket support (8) by rotating the handle anticlockwise.
- Remove O-Rings (6\*, 9\*, 11\*) from gasket support (8) and PTFE gasket (7\*) using a suitable tool in order to prevent damage.

Remove the ball (4) which was previously positioned during the closing phase. Remove the stem (3) by pushing downwards and extracting it from inside the valve body. Remove the O-Ring (2\*) from the stem (3) using a suitable tool. Remove the O-Ring (9\*) and the PTFE gasket (7\*) using a suitable tool. To assemble the valve, follow the same procedure in the opposite sequence.

**Notes:** The valve shall be supplied with a pre-set radial seal, applicable to average operating conditions; due to particular operating conditions, it might be necessary to follow the instructions below before performing the final step:

1. Disconnected the handle (1) by pulling upwards.
2. Insert the key in its seat in the gasket support (8).
3. Turn clockwise or anticlockwise to adjust as required.

**ASSEMBLY INSTRUCTIONS**  
Check Valves

**110800-110600-110900-110000**  
**110810-110610-110910-110010**

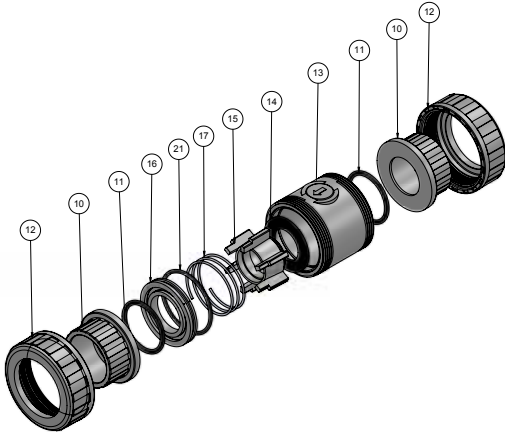

**Instructions for connection to the system -**

- A) Completely unscrew the ring nuts (12) and fit them to the pipe that the valve is to be connected to.
- B) Either glue or screw couplings (10) at the pipe ends.
- C) Position the valve body (5) between the two couplings.
- D) Lock the ring nuts for both sides.

**Instructions for disassembling and reassemble -**

- Completely unscrew the ring nuts (12).
- Remove the valve body (13) radially.
- Release the gasket support (16) by pushing it and making sure that the spring (17)

and the spring assisted piston (15) does not fall out .  
Remove the the spring assisted piston (15).  
To replace valve reverse the procedure being careful to set the O-Ring properly and grease it with silicon grease.

**116300-116900**  
**116310-116910**

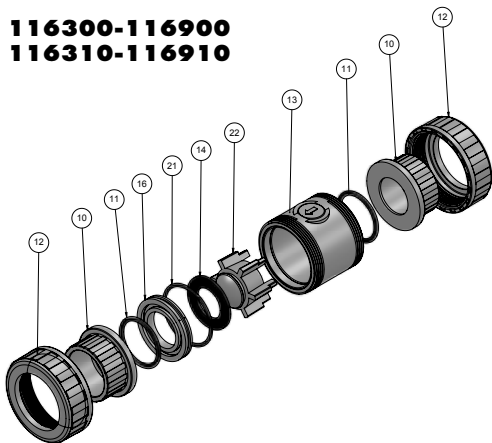

**Instructions for connection to the system -**

- A) Completely unscrew the ring nuts (12) and fit them to the pipe that the valve is to be connected to.
- B) Either glue or screw couplings (10) at the pipe ends.
- C) Position the valve body (5) between the two couplings.
- D) Lock the ring nuts for both sides.

**Instructions for disassembling and reassemble -**

- Completely unscrew the ring nuts (12).
- Remove the valve body (13) radially.
- Release the gasket support (16) by

pushing it.  
Remove the the spring assisted piston (15).  
To replace valve reverse the procedure being careful to set the O-Ring properly and grease it with silicon grease.

**116400-116000**  
**116410-116010**

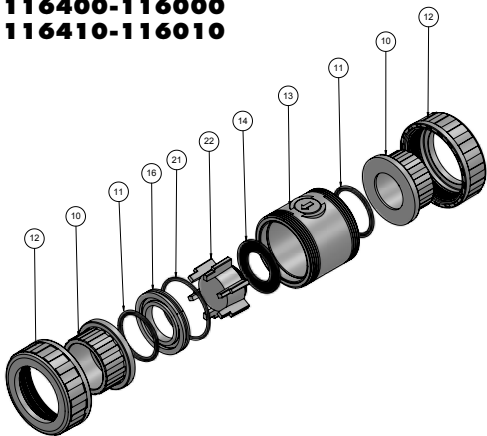

**Instructions for connection to the system -**

- A) Completely unscrew the ring nuts (12) and fit them to the pipe that the valve is to be connected to.
- B) Either glue or screw couplings (10) at the pipe ends.
- C) Position the valve body (5) between the two couplings.
- D) Lock the ring nuts for both sides.

**Instructions for disassembling and reassemble -**

- Completely unscrew the ring nuts (12).
- Remove the valve body (13) radially.
- Release the gasket support (16) by

pushing it.  
Remove the the spring assisted piston (15).  
To replace valve reverse the procedure being careful to set the O-Ring properly and grease it with silicon grease.





## **Meccanoplastica**

Via Gallinea, 28 - 16010 Mele (GE) Italy

Tel. +39 010 63.19.015 Fax. +39 010 63.19.171

email: [info@mgmeccanoplastica.it](mailto:info@mgmeccanoplastica.it) - [www.mgmeccanoplastica.eu](http://www.mgmeccanoplastica.eu)